



# TOOLTALKER

INSIDE  
MY HOUSE



MY TRAVELS



OUTSIDE  
MY HOUSE



TSA



<http://www.tooltalker.asia/>

CYLINDERS

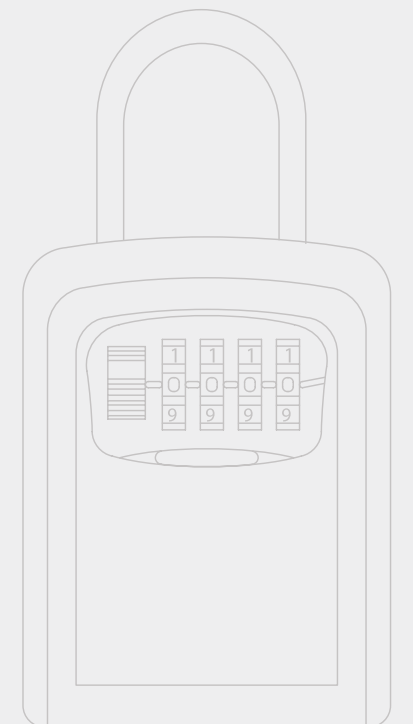

## TOOLTALKER CO.,LTD

ADD Room 708, 3rd Building of Jiaye International Town,  
NO.158 Lushan Road, Nanjing, 210019, China

TEL 86-25-8770 2701,8770 2702,8770 2703

FAX 86-25-8700 2710

E-mail Sean.mu@tooltalker.com

# CATALOG

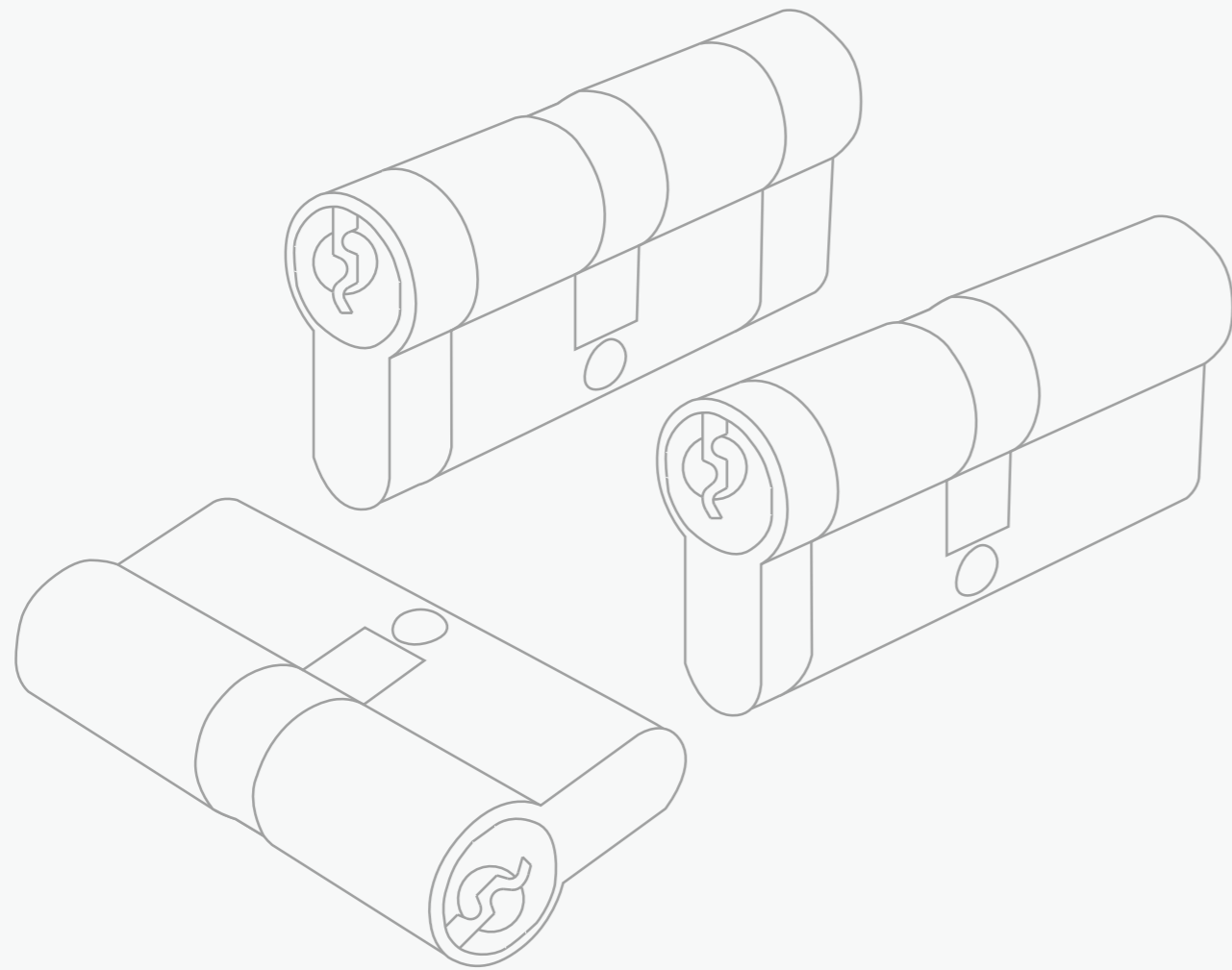

# BASIC ECONOMIC CYLINDER



## Euro Double Cylinder

- Housing - Brass/ Aluminum/Zinc Alloy
- Plug - Brass Skeleton
- Key - Steel Sawn/Dimple

## Usage

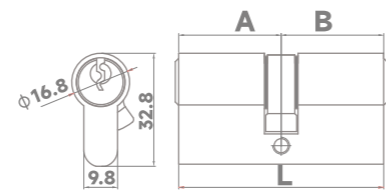

A	B	A	B
30	30	40	45
30	35	40	50
30	40	40	55
30	45	40	60
30	50	45	45
30	55	45	50
30	60	45	55
35	35	45	60
35	40	50	50
35	45	50	55
35	55	50	60
35	50	55	55
35	60	55	60
40	40	60	60



ANTI-DRILL	ANTI-SNAP	ANTI-PLUG PULL	ANTI-PICK	ANTI-BUMP	
✗	✗	✗	✓	✗	✗

# BASIC ECONOMIC CYLINDER



## Euro Double Cylinder

- Housing - Brass/ Aluminum/Zinc Alloy
- Plug - Brass Skeleton
- Key - Steel Sawn/Dimple

## Usage

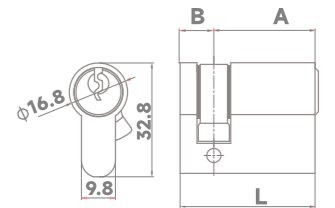

A	B
30	10
35	10
40	10
45	10
50	10
55	10
60	10



ANTI-DRILL	ANTI-SNAP	ANTI-PLUG PULL	ANTI-PICK	ANTI-BUMP	
✗	✗	✗	✓	✗	✗

# BASIC ECONOMIC CYLINDER

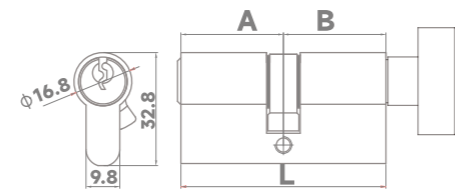

A	B	A	B
30	30	40	45
30	35	40	50
30	40	40	55
30	45	40	60
30	50	45	45
30	55	45	50
30	60	45	55
35	35	45	60
35	40	50	50
35	45	50	55
35	55	50	60
35	50	55	55
35	60	55	60
40	40	60	60

## Euro Double Cylinder

- Housing - Brass/ Aluminum/Zinc Alloy
- Plug - Brass Skeleton
- Key - Steel Sawn/Dimple

## Usage



ANTI-DRILL	ANTI-SNAP	ANTI-PLUG PULL	ANTI-PICK	ANTI-BUMP	ANTI-ROTATION
×	×	×	✓	×	×

# DIFFERENT SURFACE TREATMENT IS AVAILABLE



## Euro Double Cylinder

- Housing - Brass/ Aluminum/Zinc Alloy
- Plug - Brass Skeleton
- Key - Steel Sawn/Dimple

## Usage



ANTI-DRILL	ANTI-SNAP	ANTI-PLUG PULL	ANTI-PICK	ANTI-BUMP	ANTI-ROTATION
×	×	×	✓	×	×

# STANDARD CYLINDER



## Euro Double Cylinder

- Housing - Brass
- Plug - Brass
- Key - Steel/Brass Sawn/Dimple

## Usage

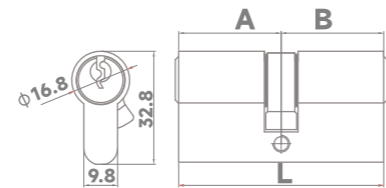

A	B	A	B
30	30	40	45
30	35	40	50
30	40	40	55
30	45	40	60
30	50	45	45
30	55	45	50
30	60	45	55
35	35	45	60
35	40	50	50
35	45	50	55
35	55	50	60
35	50	55	55
35	60	55	60
40	40	60	60



ANTI-DRILL	ANTI-SNAP	ANTI-PLUG PULL	ANTI-PICK	ANTI-BUMP	ANTI-DRILL
○	×	×	✓	×	○

# STANDARD CYLINDER



## Euro Double Cylinder

- Housing - Brass
- Plug - Brass
- Key - Steel/Brass Sawn/Dimple

## Usage

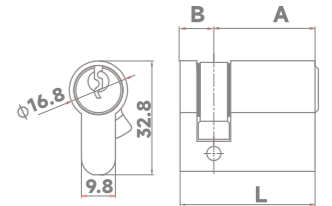

A	B
30	10
35	10
40	10
45	10
50	10
55	10
60	10



ANTI-DRILL	ANTI-SNAP	ANTI-PLUG PULL	ANTI-PICK	ANTI-BUMP	ANTI-DRILL
○	×	×	✓	×	○

# STANDARD CYLINDER

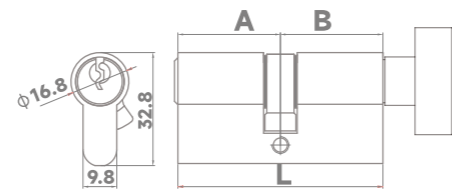

A	B	A	B
30	30	40	45
30	35	40	50
30	40	40	55
30	45	40	60
30	50	45	45
30	55	45	50
30	60	45	55
35	35	45	60
35	40	50	50
35	45	50	55
35	55	50	60
35	50	55	55
35	60	55	60
40	40	60	60

## Euro Double Cylinder

- Housing - Brass
- Plug - Brass
- Key - Steel/Brass Sawn/Dimple

## Usage



ANTI-DRILL	ANTI-SNAP	ANTI-PLUG PULL	ANTI-PICK	ANTI-BUMP	ANTI-ROTATION
○	×	×	✓	×	○

# DIFFERENT SURFACE TREATMENT IS AVAILABLE



## Euro Double Cylinder

- Housing - Brass
- Plug - Brass
- Key - Steel/Brass Sawn/Dimple

## Usage



ANTI-DRILL	ANTI-SNAP	ANTI-PLUG PULL	ANTI-PICK	ANTI-BUMP	ANTI-ROTATION
○	×	×	✓	×	○

# SECURITY CYLINDER



## Euro Double Cylinder

- Housing - Brass
- Plug - Brass
- Key - Steel/Brass Sawn/Dimple

## Usage

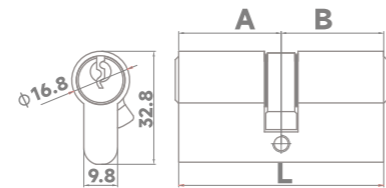

A	B	A	B
30	30	40	45
30	35	40	50
30	40	40	55
30	45	40	60
30	50	45	45
30	55	45	50
30	60	45	55
35	35	45	60
35	40	50	50
35	45	50	55
35	55	50	60
35	50	55	55
35	60	55	60
40	40	60	60



ANTI-DRILL	ANTI-SNAP	ANTI-PLUG PULL	ANTI-PICK	ANTI-BUMP	ANTI-DRILL
✓	○	✓	✓	✓	○

# SECURITY CYLINDER



## Euro Double Cylinder

- Housing - Brass
- Plug - Brass
- Key - Steel/Brass Sawn/Dimple

## Usage

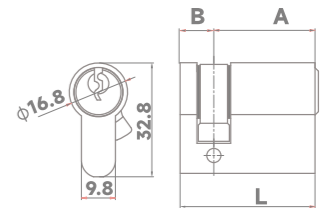

A	B
30	10
35	10
40	10
45	10
50	10
55	10
60	10



ANTI-DRILL	ANTI-SNAP	ANTI-PLUG PULL	ANTI-PICK	ANTI-BUMP	ANTI-DRILL
✓	○	✓	✓	✓	○

# SECURITY CYLINDER

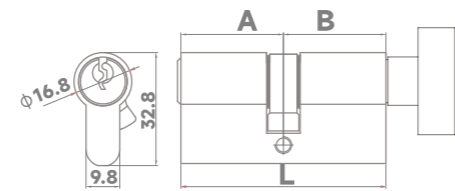

A	B	A	B
30	30	40	45
30	35	40	50
30	40	40	55
30	45	40	60
30	50	45	45
30	55	45	50
30	60	45	55
35	35	45	60
35	40	50	50
35	45	50	55
35	55	50	60
35	50	55	55
35	60	55	60
40	40	60	60

## Euro Double Cylinder

- Housing - Brass
- Plug - Brass
- Key - Steel/Brass Sawn/Dimple

## Usage



ANTI-DRILL	ANTI-SNAP	ANTI-PLUG PULL	ANTI-PICK	ANTI-BUMP	ANTI-ROTATION
✓	○	✓	✓	✓	○

# DIFFERENT SURFACE TREATMENT IS AVAILABLE



## Euro Double Cylinder

- Housing - Brass
- Plug - Brass
- Key - Steel/Brass Sawn/Dimple

## Usage

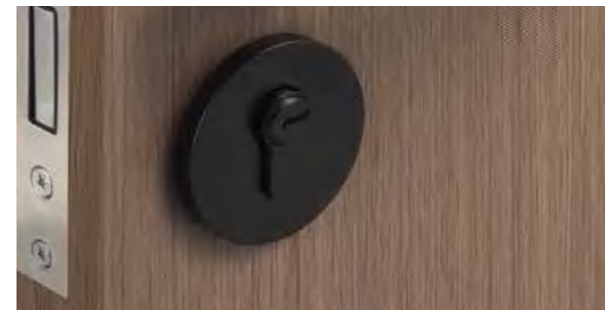

ANTI-DRILL	ANTI-SNAP	ANTI-PLUG PULL	ANTI-PICK	ANTI-BUMP	ANTI-ROTATION
✓	○	✓	✓	✓	○

# SECURITY CYLINDER

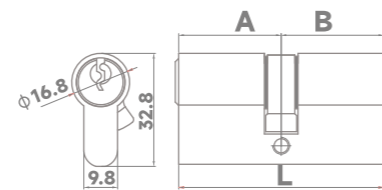

A	B	A	B
30	30	40	45
30	35	40	50
30	40	40	55
30	45	40	60
30	50	45	45
30	55	45	50
30	60	45	55
35	35	45	60
35	40	50	50
35	45	50	55
35	55	50	60
35	50	55	55
35	60	55	60
40	40	60	60

## Euro Double Cylinder

- Housing - Brass
- Plug - Brass
- Key - Steel Sawn/Dimple

## Usage



ANTI-DRILL	ANTI-SNAP	ANTI-PLUG PULL	ANTI-PICK	ANTI-BUMP	ANTI-ROTATION
✓	✓	✓	✓	✓	○

# DIFFERENT SURFACE TREATMENT IS AVAILABLE



## Euro Double Cylinder

- Housing - Brass
- Plug - Brass
- Key - Steel/Brass Sawn/Dimple

## Usage



ANTI-DRILL	ANTI-SNAP	ANTI-PLUG PULL	ANTI-PICK	ANTI-BUMP	ANTI-ROTATION
✓	✓	✓	✓	✓	○

**BC**

**NEW!**

## BLACK CYLINDER

- European brass profile, 6 pin mechanism.
- According to requirements, provide the number of equipped keys.

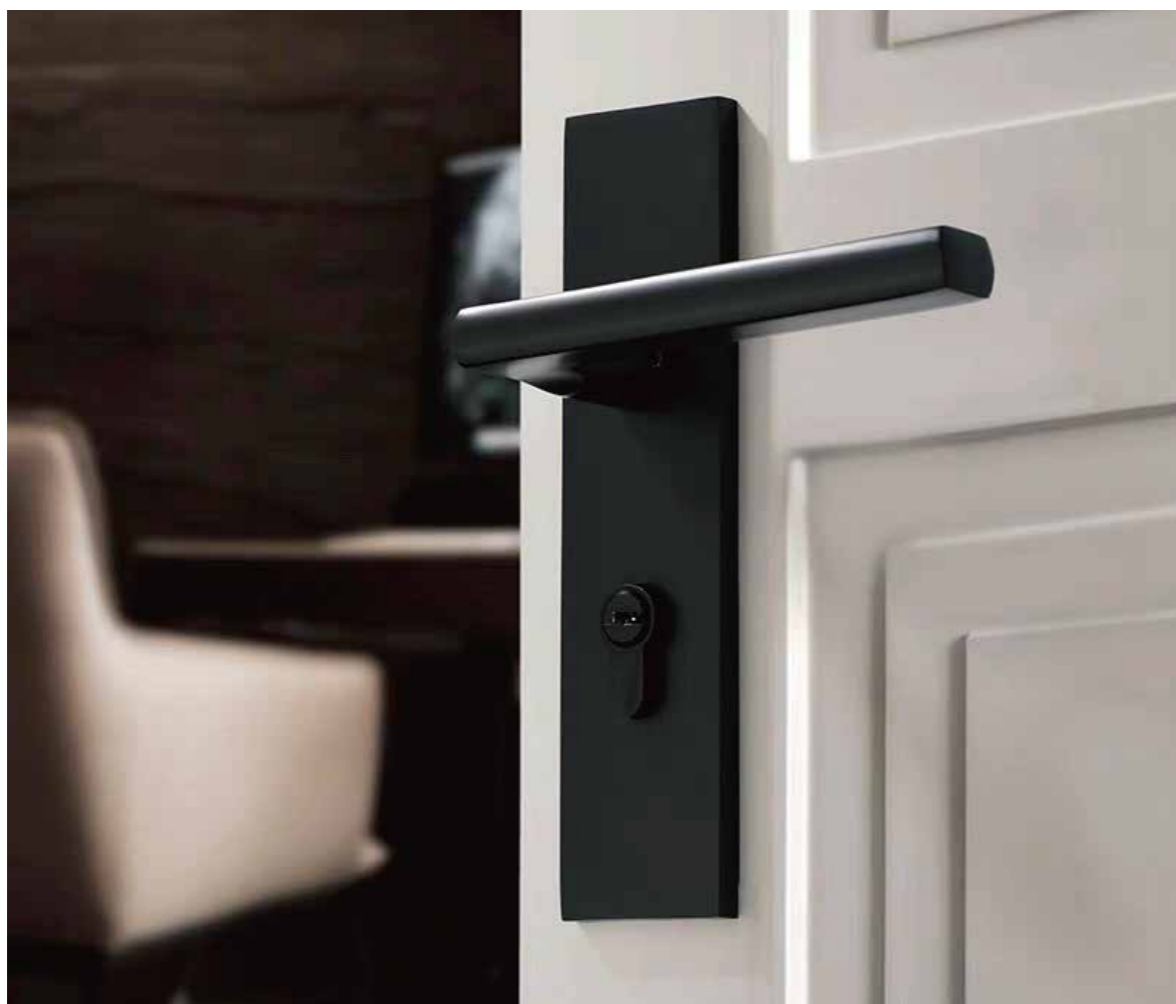

## BLACK CYLINDER



### Euro Double Cylinder

- Housing - Brass
- Plug - Brass
- Key - Steel/Brass Sawn/Dimple

### Usage



# LOCK CYLINDER STRUCTURE

# CYLINDER LOCK

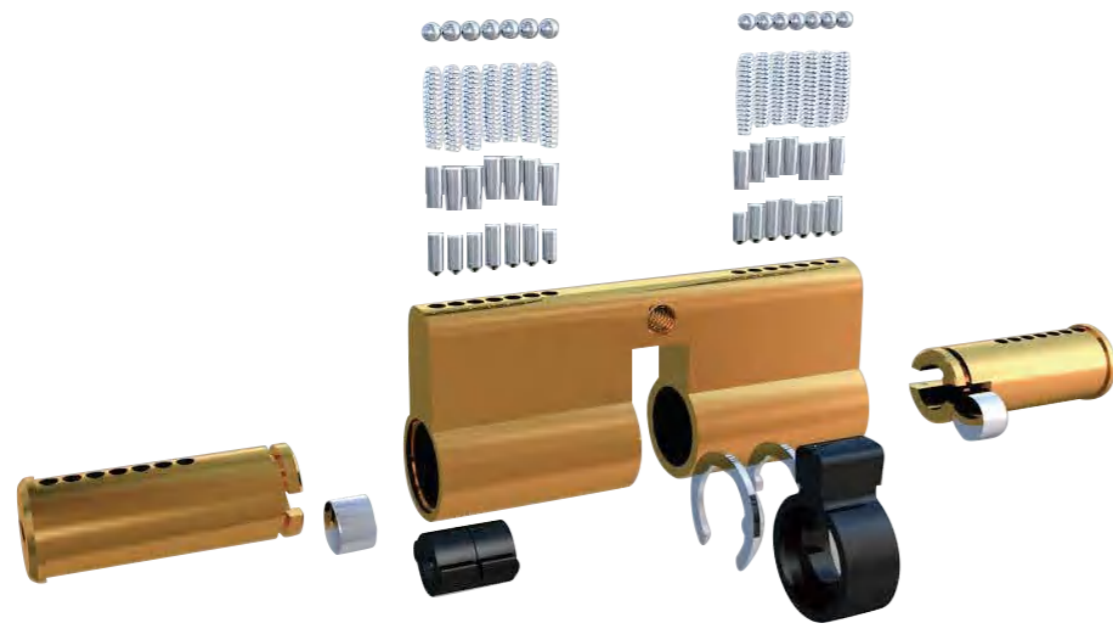

## Technical Data

- Brass body , hardened-steel shackle.
- Double-locking bolts with 4 brass wheels

## Usage



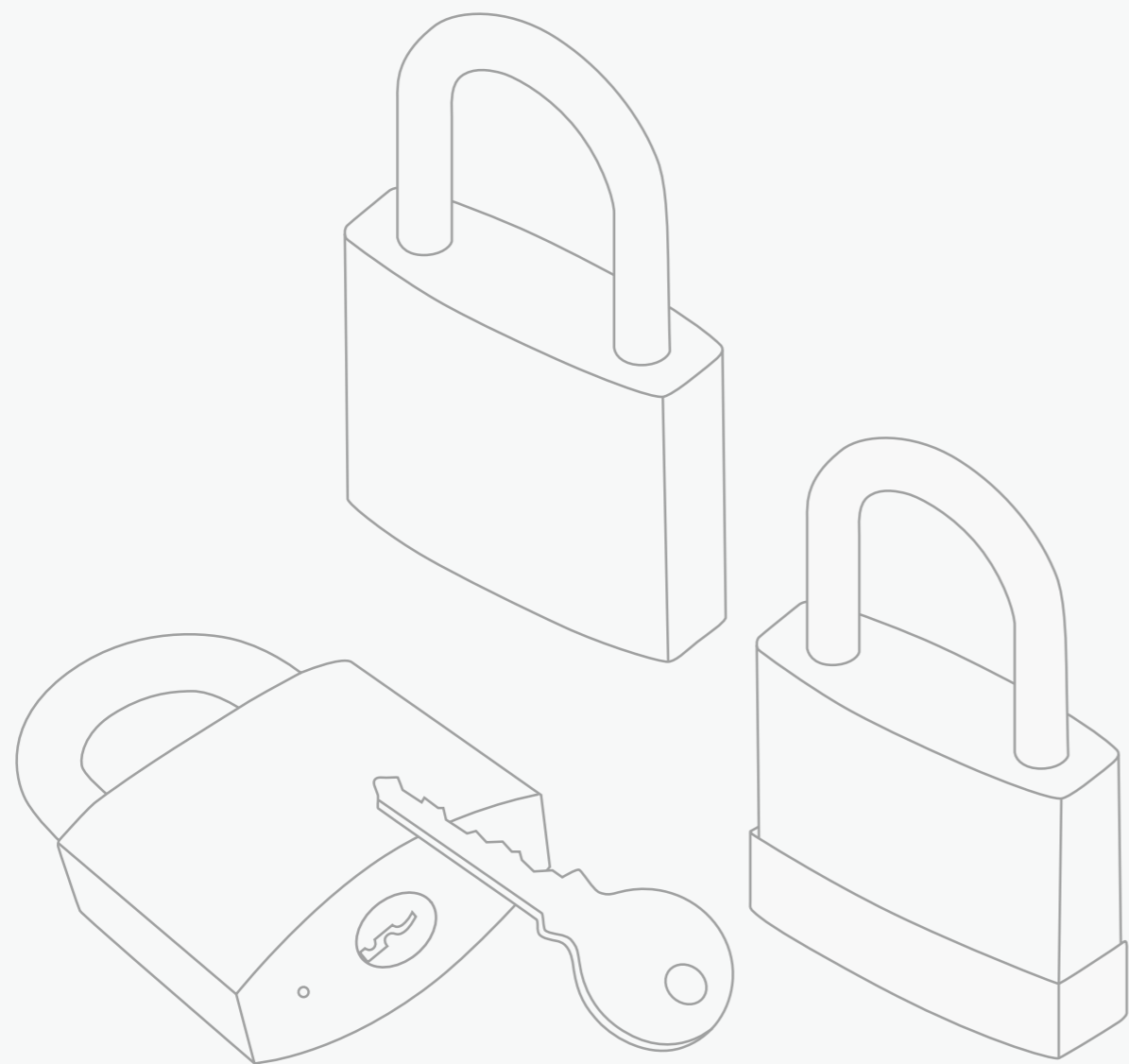

# CATALOG

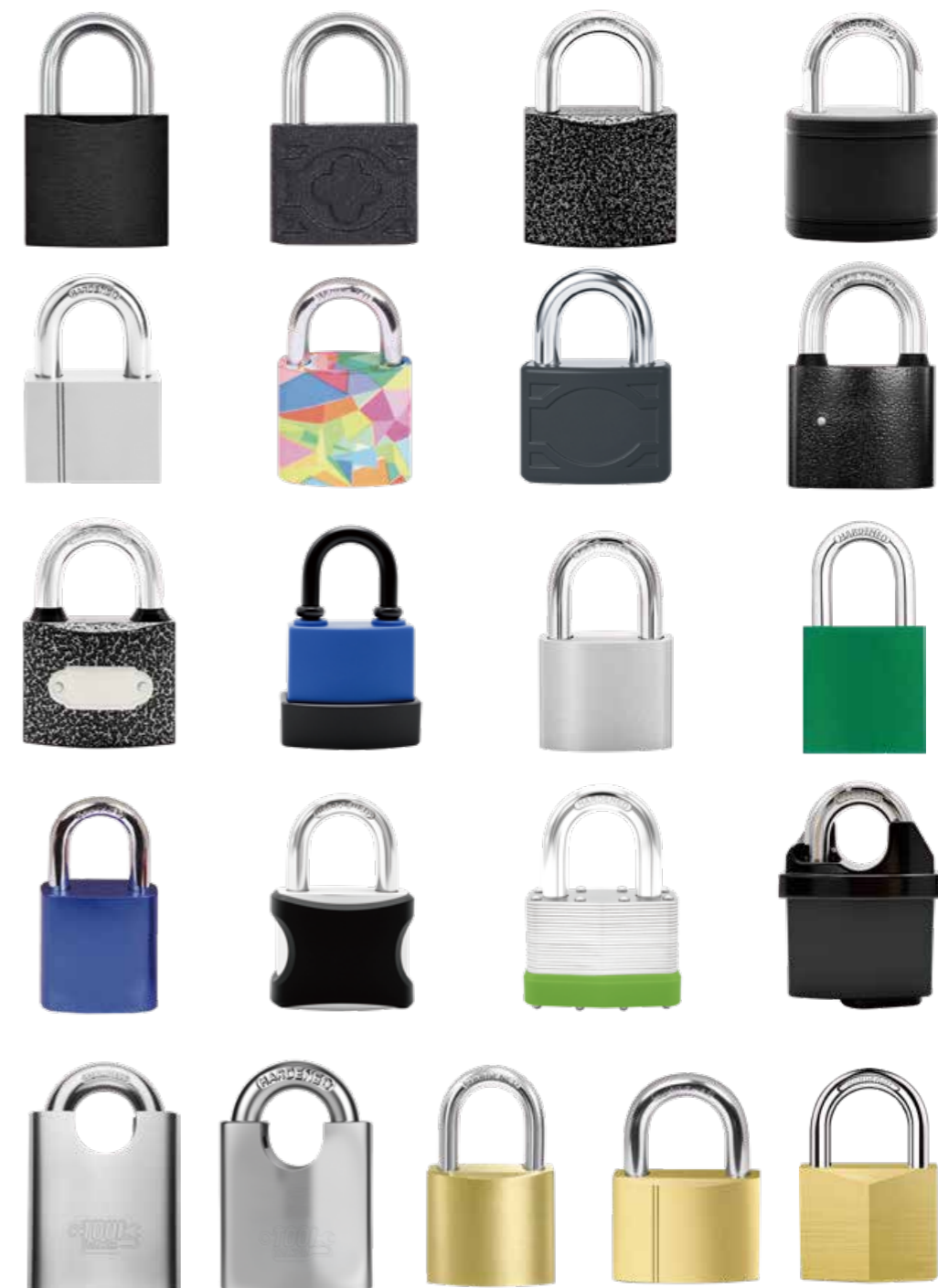

# IRON PADLOCK TTLKIP

Security level



## Technical Data

- Iron lock body , Steel shackle with chrome plated.
- Brass cylinder.
- Surface finish: Painting.
- 3 nickel-plated steel keys.

## Usage



## Keyed Alike Available

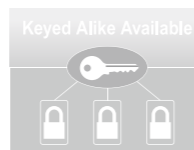

Product Number	SIZE (mm)	Shackle and lock body dimensions (mm)					
		A	B	C	D	E	F
<b>Short Shankle</b>							
TTLKIP20	24	24	21	11.5	3.3	10.7	13.3
TTLKIP30	35	35	30	16	5.3	17	16.8
TTLKIP40	41	41	33.8	21.1	6.3	19.7	17.8
TTLKIP50	54	54	41	26	9	25	22
TTLKIP65	67	67	50	33	10.5	32.6	24.8
<b>Long Shankle</b>							
TTLKIP30L	35	35	30	47.6	5.3	17	16.8
TTLKIP40L	41	41	33.8	56	6.3	19.7	17.8
TTLKIP50L	54	54	41	61	9	25	22
TTLKIP65L	67	67	50	72.3	10.5	32.6	24.8

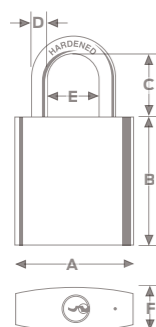

# IRON PADLOCK TTLKIPF

Security level

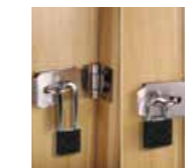

## Technical Data

- Iron lock body , Steel shackle with chrome plated.
- Brass cylinder.
- Surface finish: Painting.
- 3 nickel-plated steel keys.

## Usage



## Keyed Alike Available

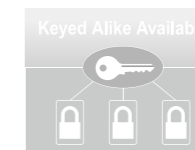

Product Number	SIZE (mm)	Shackle and lock body dimensions (mm)					
		A	B	C	D	E	F
<b>Short Shankle</b>							
TTLKIPF20	24	24	21	11.5	3.3	10.7	13.3
TTLKIPF30	35	35	30	16	5.3	17	16.8
TTLKIPF40	41	41	33.8	21.1	6.3	19.7	17.8
TTLKIPF50	54	54	41	26	9	25	22
TTLKIPF65	67	67	50	33	10.5	32.6	24.8
<b>Long Shankle</b>							
TTLKIPF30L	35	35	30	47.6	5.3	17	16.8
TTLKIPF40L	41	41	33.8	56	6.3	19.7	17.8
TTLKIPF50L	54	54	41	61	9	25	22
TTLKIPF65L	67	67	50	72.3	10.5	32.6	24.8

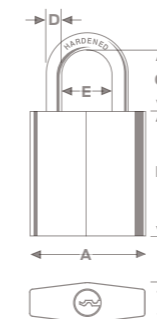

# IRON PADLOCK TTLKIPS

Security level



## Technical Data

- Iron lock body ,  
Hardened steel shackle with chrome plated.
- Brass cylinder.
- Surface finish: Painting.
- 3 nickel-plated steel keys.

## Usage



## Keyed Alike Available

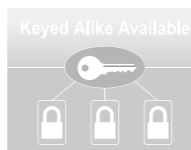

Product Number	SIZE (mm)	Shackle and lock body dimensions (mm)					
		A	B	C	D	E	F
<b>Short Shankle</b>							
TTLKIPS20	24	24	21	11.5	3.3	10.7	13.3
TTLKIPS30	35	35	30	16	5.3	17	16.8
TTLKIPS40	41	41	33.8	21.1	6.3	19.7	17.8
TTLKIPS50	54	54	41	26	9	25	22
TTLKIPS65	67	67	50	33	10.5	32.6	24.8
<b>Long Shankle</b>							
TTLKIPS30L	35	35	30	47.6	5.3	17	16.8
TTLKIPS40L	41	41	33.8	56	6.3	19.7	17.8
TTLKIPS50L	54	54	41	61	9	25	22
TTLKIPS65L	67	67	50	72.3	10.5	32.6	24.8

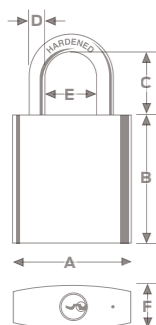

# IRON PADLOCK TTLKIPP

Security level



## Technical Data

- Iron lock body ,  
Hardened steel shackle with chrome plated.
- Brass cylinder.
- Surface finish: Plastic cover.
- 3 nickel-plated steel keys.

## Usage



## Keyed Alike Available

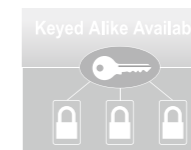

Product Number	SIZE (mm)	Shackle and lock body dimensions (mm)					
		A	B	C	D	E	F
<b>Short Shankle</b>							
TTLKIPP20	24	24	21	11.5	3.3	10.7	13.3
TTLKIPP30	35	35	30	16	5.3	17	16.8
TTLKIPP40	41	41	33.8	21.1	6.3	19.7	17.8
TTLKIPP50	54	54	41	26	9	25	22
TTLKIPP65	67	67	50	33	10.5	32.6	24.8
<b>Long Shankle</b>							
TTLKIPP30L	35	35	30	47.6	5.3	17	16.8
TTLKIPP40L	41	41	33.8	56	6.3	19.7	17.8
TTLKIPP50L	54	54	41	61	9	25	22
TTLKIPP65L	67	67	50	72.3	10.5	32.6	24.8

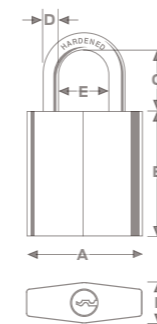

# IRON PADLOCK USBP

Security level



Technical Data

- Iron body with chrome plating is strong durable.
- Hardened steel shackle.
- Disc mechanism system.

Usage



Keyed Alike Available

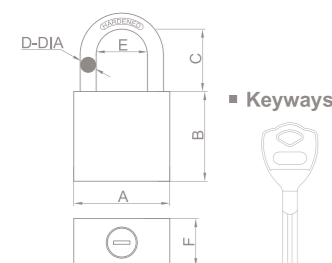
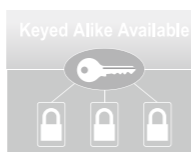

Product Number	SIZE (mm)	Shackle and lock body dimensions (mm)					
		A	B	C	D	E	F
<b>Short Shankle</b>							
USBP30	30	30	26	17.5	5.0	14.9	15
USBP35	35	35	30	21.2	6.3	17.7	20
USBP40	40	40	33	24.5	7.0	20.0	20
USBP45	45	45	36	26.4	8.0	23.0	20
USBP50	50	50	39	28.5	9.0	25.0	20
USBP60	60	60	45	32.0	11.0	30.0	20
USBP70	70	70	51	37.0	13.0	35.0	22

# COLORFUL IRON PADLOCK TTLKCP30

Security level



Technical Data

- Iron lock body, Steel with chrome plated.
- Brass cylinder.
- 3 iron keys.

Usage



Keyed Alike Available

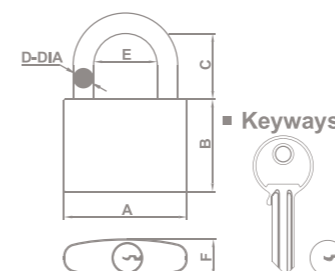
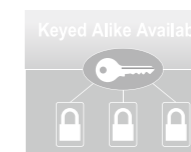

Product Number	SIZE (mm)	Shackle and lock body dimensions (mm)					
		A	B	C	D	E	F
TTLKCP30	30	32	30	16	5.3	16.7	13.5

# IRON PADLOCK PCIP

Security level



Technical Data

- Iron lock body , Steel with chrome plated.
- Brass cylinder.
- 3 steel keys.

Usage



Keyed Alike Available

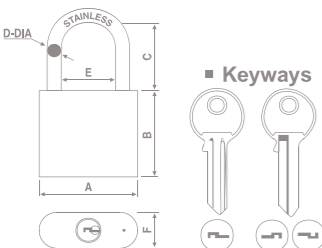

Product Number	SIZE (mm)	Shackle and lock body dimensions (mm)					
		A	B	C	D	E	F
<b>Short Shankle</b>							
PCIP20	30	35.4	30	15.9	5.3	16.7	16.9
PCIP25	40	41.4	34	21.7	6.3	19.7	18.4
PCIP30	50	54.0	41	25.5	9	25	22.0
PCIP40	60	67.4	50	32.3	10.5	32.5	25.4
PCIP50	75	79.0	58	40	12	39	29.0

# IRON PADLOCK USBP

Security level



Technical Data

- Iron lock body , Steel shackle with chrome plated.
- Brass cylinder.
- 3 steel keys.
- 2 waterproof rings.

Usage



Keyed Alike Available

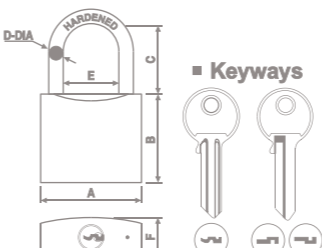
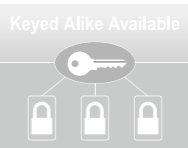

Product Number	SIZE (mm)	Shackle and lock body dimensions (mm)					
		A	B	C	D	E	F
<b>Short Shankle</b>							
USBP20	20	21	21	11.1	3.3	10.7	10.5
USBP25	25	25	24	13.9	4.3	12.7	11.5
USBP32	32	32	30	16.5	5.3	10.7	13.5
USBP38	38	38	34	21.4	6.3	19.7	15
USBP50	50	50	41	25	9	25	18
USBP60	60	63	50	32.3	10.5	32.5	21
USBP75	75	74	58	40.5	12	39	24

# IRON PADLOCK IP

Security level



Technical Data

- Iron lock body , Steel shackle with chrome plated.
- Brass cylinder.
- 3 steel keys.
- 2 waterproof rings.

Usage



Keyed Alike Available

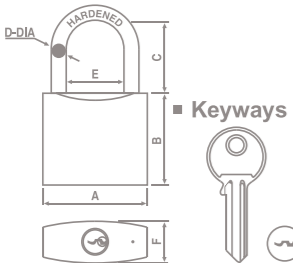
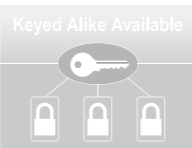

Product Number	SIZE (mm)	Shackle and lock body dimensions (mm)					
		A	B	C	D	E	F
<b>Short Shankle</b>							
IP20	20	21	21	11.1	3.3	10.7	11
IP25	2.5	25	24	13.8	4.3	12.7	12.5
IP30	3.2	32	30	16.4	5.3	10.7	15
IP40	3.8	38	34	21.4	6.3	19.7	17.7
IP50	5.0	50	41	25	9	25	23
IP60	6.0	63	50	32.3	10.5	32.5	26.5
IP75	7.5	75	58	40	12	39	28

# IRON PADLOCK IPWB

Security level



Technical Data

- Iron lock body , Steel with chrome plated.
- Steel/Brass cylinder.
- 3 nickel plated steel keys.

Usage



Keyed Alike Available

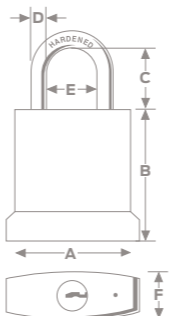
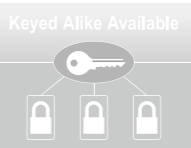

Product Number	SIZE (mm)	Shackle and lock body dimensions (mm)					
		A	B	C	D	E	F
<b>Short Shankle</b>							
IPWB40	40	47	39	24	7.3	19	25.5
IPWB50	5.0	58	47	26.5	9.5	24.5	30
IPWB60	6.0	72	57	36	11.5	31.5	33.5
<b>Long Shankle</b>							
IPWB40L	40	47	27	51.5	7.3	19	25.5
IPWB50L	5.0	58	33	55	9.5	24.5	30
IPWB60L	6.0	72	39	73	11.5	31.5	33.5

# ALUMINUM PADLOCK TTLKAP

Security level

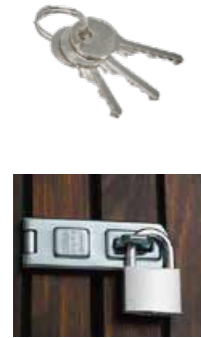

Technical Data

- Aluminum lock body ,  
Hardened steel shackle with chrome plated.
- Brass cylinder.
- 3 nickel plated steel keys.

Usage



Keyed Alike Available

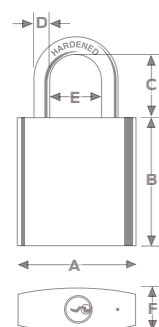
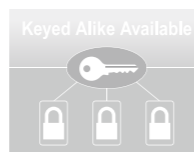

Product Number	SIZE (mm)	Shackle and lock body dimensions (mm)					
		A	B	C	D	E	F
<b>Short Shankle</b>							
TTLKAP30	30	30	27	16.1	5	15	13
TTLKAP40	40	40	33	23	6.3	20.7	14
TTLKAP50	50	50	39	26	8	26	16
<b>Long Shankle</b>							
TTLKAP30L	30	30	27	47.1	5	15	13
TTLKAP40L	40	40	33	51.8	6.3	20.7	14
TTLKAP50L	50	50	39	55	8	26	16

# ALUMINUM PADLOCK TTLKAPG30

Security level



Aluminum alloy key lock function



Technical Data

- Aluminum padlocks are the lightest aluminum locks on the market, made of recycled materials.
- The standard size of the lock body is 1.6 inches. H x 1.5 "W x 0.75" D
- Bright anodized finish provides greater visibility and fade resistance in all environments
- The reserved parallel center keyway provides the best security (to prevent someone from getting a copy made at the local key store)
- Aluminum shackles have excellent fire resistance and corrosion resistance

Usage



Keyed Alike Available

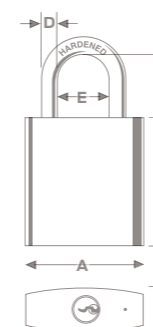
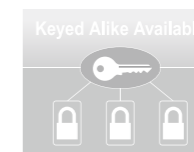

Product Number	SIZE (mm)	Shackle and lock body dimensions (mm)					
		A	B	C	D	E	F
TTLKAPG30	37	37	40	28	5	20	19

# ALUMINUM PADLOCK TTLKPM40

Security level



## Technical Data

- Aluminum Lock Body, Several Colors Available
- Brass Cylinder
- Pin mechanism
- Nickle Plated Brass Keys
- Hardened Steel Shackle

## Usage



## Keyed Alike Available

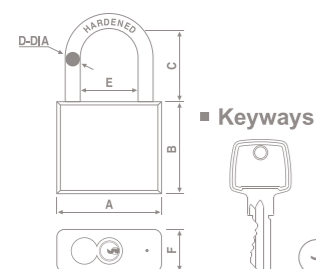
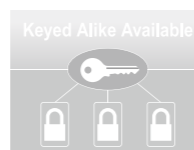

Product Number	SIZE (mm)	Shackle and lock body dimensions (mm)					
		A	B	C	D	E	F
TTLKPM40	40	38	39	25	7	18	19

# ALUMINUM PADLOCK TTLKAPP

Security level

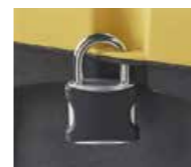

## Technical Data

- Aluminum lock body with plastic cover, Hardened-steel shackle.
- Brass cylinder.
- 3 nickel plated steel keys.

## Usage



## Keyed Alike Available

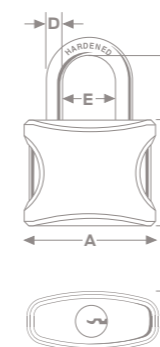
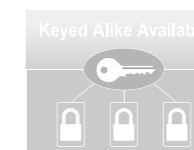

Product Number	SIZE (mm)	Shackle and lock body dimensions (mm)					
		A	B	C	D	E	F
<b>Short Shankle</b>							
TTLKAPP20	20	24	21	11.2	3.3	10.7	13.3
TTLKAPP25	25	29	24	14	6.3	12.7	15.4
TTLKAPP30	30	36	30	16.4	5.3	16.7	17.4
TTLKAPP40	40	42	34	21.3	6.3	19.7	19
TTLKAPP50	50	54.7	41	25	9	25	22.7

# LAMINATED PADLOCK TTLKLP

Security level



Technical Data

- Laminated steel lock body ,  
Hardened-steel shackle.
- Brass cylinder.
- 3 nickel plated steel keys.

Usage



Keyed Alike Available

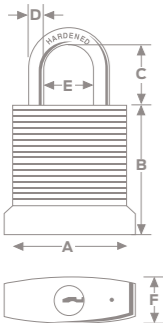
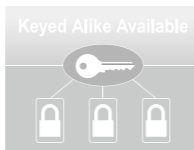

Product Number	SIZE (mm)	Shackle and lock body dimensions (mm)					
		A	B	C	D	E	F
<b>Short Shankle</b>							
TTLKLP30	30	31	26.8	18	4.95	14.5	17.5
TTLKLP40	40	40	33	24	6.4	20.5	22.5
TTLKLP50	50	50	37.5	27.5	8.8	24.5	26
TTLKLP65	65	65	45	38	11	30	31
<b>Long Shankle</b>							
TTLKLP40L	40	40	33	53	6.1	20.5	22.5
TTLKLP50L	50	50	37.5	61	8.8	24.5	26
TTLKLP65L	65	65	45	88	11	30	31

# IRON PADLOCK SEIWF

Security level



Technical Data

- Iron body aluminium head padlock  
water-proof
- Surface: colors for your choice
- Key system: 4 Waterproof plastic headed steel keys

Usage



Technology

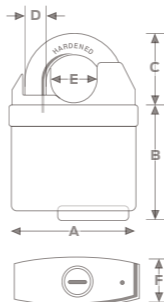

Product Number	SIZE (mm)	Shackle and lock body dimensions (mm)					
		A	B	C	D	E	F
<b>Short Shankle</b>							
SEIWF50	50	52.2	45	19.5	9.0	20.5	28.8
SEIWF60	60	65.2	53	25	10.8	23.0	31.2

# SEMI-ENCLOSED STEEL PADLOCK

Security level



Technical Data

- Steel lock body , hardened-steel shackle.
- Brass cylinder.
- 3 nickel plated steel keys.

Usage



Technology

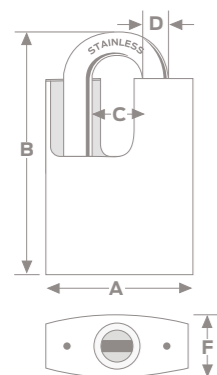

Product Number	SIZE (mm)	Shackle and lock body dimensions (mm)					
		A	B	C	D	E	F
<b>Short Shankle</b>							
SEIWF40	40	40	60	24.8	7	18	21
SEIWF50	50	50	70	28.5	9	23	23
SEIWF60	60	60	80	32	11	25	25

# SEMI-ENCLOSED STEEL PADLOCK

Security level



Technical Data

- Steel lock body , Stainless steel shackle.
- Brass cylinder.
- 3 nickel plated steel keys.

Usage



Technology

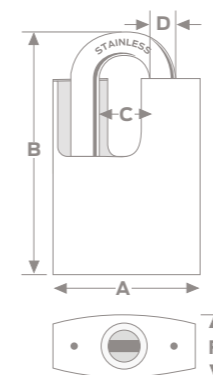

Product Number	SIZE (mm)	Shackle and lock body dimensions (mm)					
		A	B	C	D	E	F
<b>Short Shankle</b>							
SSEIWF40	40	40	60	24.8	7	18	21
SSEIWF50	50	50	70	28.5	9	23	23
SSEIWF60	60	60	80	32	11	25	25

# HEAVY-DUTY IRON COMBINATION PADLOCK

Security level



## Technical Data

- Iron body , hardened-steel shackle.
- Double-locking bolts with 4 brass wheels

## Usage



## Technology

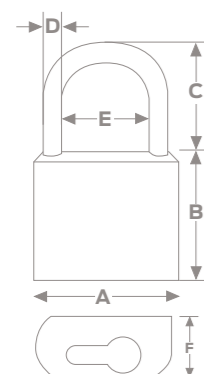
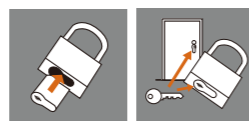

Product Number	SIZE (mm)	Shackle and lock body dimensions (mm)					
		A	B	C	D	E	F
<b>Iron combination padlock</b>							
TTLKBPD50	50	50	45	40	8	27	26

# BRASS PADLOCK TTLKBR

Security level

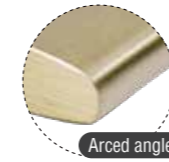

## Technical Data

- Brass lock body , Hardened-steel shackle.
- Brass cylinder.
- 3 nickel plated steel keys.

## Usage



## Keyed Alike Available

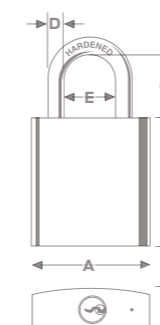
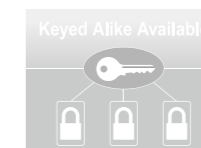

Product Number	SIZE (mm)	Shackle and lock body dimensions (mm)					
		A	B	C	D	E	F
<b>Short Shankle</b>							
TTLKBR30	30	30	27	16.1	5	15	13
TTLKBR40	40	40	33	23	6.3	20.7	14
TTLKBR50	50	50	39	26	8	26	16
<b>Long Shankle</b>							
TTLKBR30L	30	30	27	47.1	5	15	13
TTLKBR40L	40	40	33	51.8	6.3	20.7	14
TTLKBR50L	50	50	39	55	8	26	16

# BRASS PADLOCK TTLKBBR

Security level



Technical Data

- Brass lock body , Hardened-steel shackle.
- Brass cylinder.
- 3 nickel plated steel keys.

Usage



Keyed Alike Available

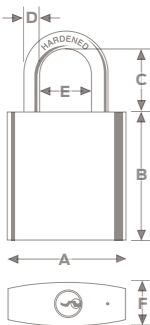

Product Number	SIZE (mm)	Shackle and lock body dimensions (mm)					
		A	B	C	D	E	F
<b>Short Shankle</b>							
TTLKBBR20	20	21	21	11.1	3.3	10.7	10.5
TTLKBBR25	25	25	24	13.9	4.3	12.7	11.5
TTLKBBR30	30	30	27	16.1	5.0	15.0	13.0
TTLKBBR40	40	40	33	21.8	6.3	20.7	14.0
TTLKBBR50	50	50	39	25.0	8.0	26.0	16.0
TTLKBBR60	60	60	45	32.0	10.0	31.0	18.5
TTLKBBR70	70	70	51	37	11.0	39.0	20.0

# DIAMOND BRASS PADLOCK TTLKDB

Security level



Technical Data

- Brass lock body , Hardened-steel shackle.
- Brass cylinder.
- 3 nickel plated steel keys.

Usage



Keyed Alike Available

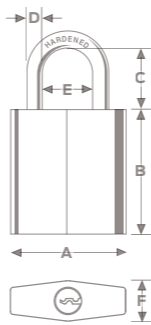
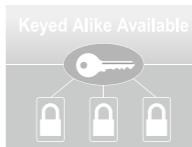

Product Number	SIZE (mm)	Shackle and lock body dimensions (mm)					
		A	B	C	D	E	F
<b>Short Shankle</b>							
TTLKDB30	30	30	27	16.1	5	15	13
TTLKDB40	40	40	33	23	6.3	20.7	14
TTLKDB50	50	50	39	26	8	26	16
<b>Long Shankle</b>							
TTLKDB30L	30	30	27	47.1	5	15	13
TTLKDB40L	40	40	33	51.8	6.3	20.7	14
TTLKDB50L	50	50	39	55	8	26	16

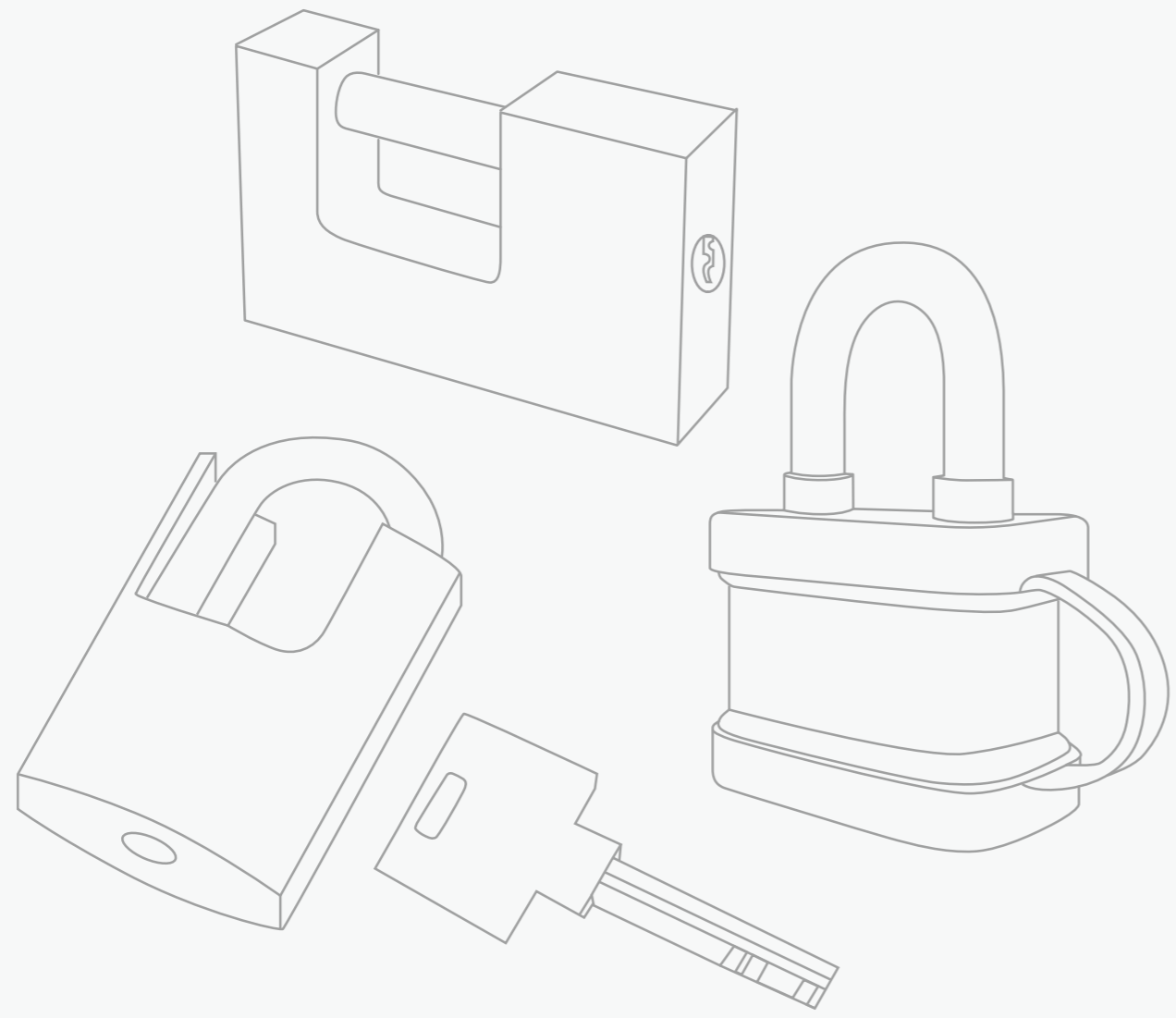

# CATALOG

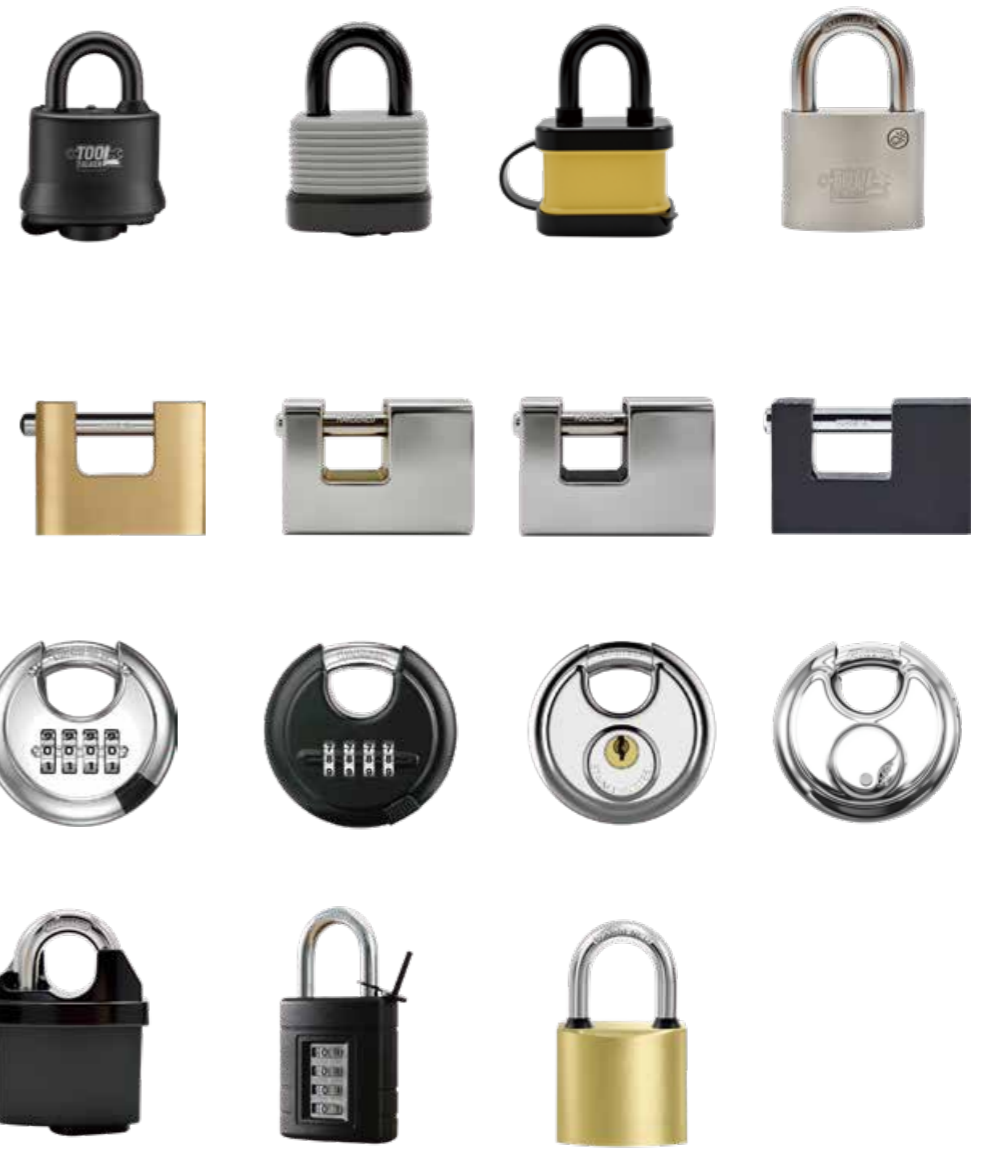

# IRON PADLOCK IPWBL

Security level

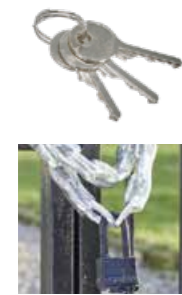

Technical Data

- Iron lock body , Steel shackle.
- Brass cylinder.
- 3 nickel plated steel keys.

Usage



Keyed Alike Available

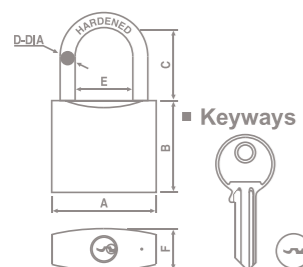
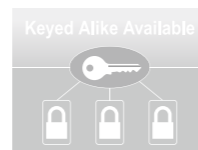

Product Number	SIZE (mm)	Shackle and lock body dimensions (mm)					
		A	B	C	D	E	F
<b>Short Shankle</b>							
IPWBL30	30	34.85	31	19.25	13.5	6.3	25
IPWBL40	40	40	33	19.5	19.5	7.5	31
IPWBL50	50	50	37.5	23	22.5	10.5	35
IPWBL70	70	65	45	32.75	28	12.9	40
<b>Long Shankle</b>							
IPWBL40L	40	40	40	46	19.5	7.5	31
IPWBL65L	65	44	44	57	22.5	10.5	35

# LAMINATED STEEL PADLOCK TTLKIPWY

Security level



Technical Data

- Laminated steel body , Steel shackle.
- Brass cylinder.
- 3 nickel plated steel keys.

Usage



Keyed Alike Available

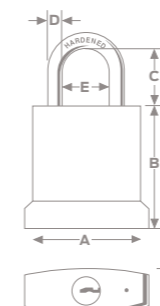
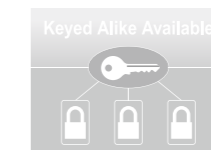

Product Number	SIZE (mm)	Shackle and lock body dimensions (mm)					
		A	B	C	D	E	F
<b>Short Shankle</b>							
TTLKIPWY30	30	31	26.8	18	4.95	14.5	17.5
TTLKIPWY40	40	40	33	24	6.4	20.5	22.5
TTLKIPWY50	50	50	37.5	27.5	8.8	24.5	26
TTLKIPWY65	65	65	45	38	11	30	31
<b>Long Shankle</b>							
TTLKIPWY40L	40	40	33	53	6.1	20.5	22.5
TTLKIPWY50L	50	50	37.5	61	8.8	24.5	26
TTLKIPWY65L	65	65	45	88	11	30	31

# WATERPROOF LAMINATED STEEL PADLOCK TTLKIPWG

Security level



## Technical Data

- Laminated steel body ,  
Hardened-steel shackle.
- Brass cylinder.
- 3 nickel plated steel keys.

## Usage



## Keyed Alike Available

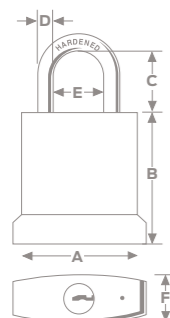
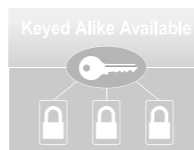

Product Number	SIZE (mm)	Shackle and lock body dimensions (mm)					
		A	B	C	D	E	F
<b>Short Shankle</b>							
TTLKIPWG40	40	47	39	24	7.3	19	25.5
TTLKIPWG50	50	58	47	26.5	9.5	24.5	30
TTLKIPWG60	60	72	57	36	11.5	31.5	33.5

# STAINLESS STEEL PADLOCK SSP

Security level



## Technical Data

- Stainless Steel body ,  
hardened-steel shackle.
- Brass cylinder.
- 3 nickel plated steel keys.

## Usage



## Technology

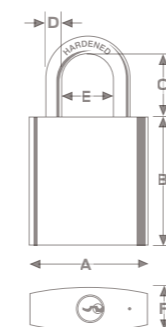

Product Number	SIZE (mm)	Shackle and lock body dimensions (mm)					
		A	B	C	D	E	F
<b>Short Shankle</b>							
TTLKSSP32	32	32	30	15.9	5.3	16.7	13.5
TTLKSSP38	38	38	34	21.4	6.3	19.7	15
TTLKSSP50	50	50	41	26	9	25	18
TTLKSSP63	63	63	50	32.3	10.5	32.5	21

# RECTANGLE TYPE BRASS PADLOCK TTLKRBP

Security level



## Technical Data

- Brass lock body with stainless steel cover , hardened-steel shackle with chrome plated.
- Brass cylinder.  
3 nickel plated steel keys.

## Usage



## Technology



Product Number	SIZE (mm)	Shackle and lock body dimensions (mm)					
		A	B	C	D	E	F
<b>Short Shankle</b>							
TTLKRBP50	50	51	38	10.6	14	7.8	15
TTLKRBP60	60	60	38	10.6	20	7.8	15
TTLKRBP75	75	75	50	14.6	25	11.8	18
TTLKRBP90	90	90	60	19.6	36	11.8	20

# RECTANGLE TYPE STEEL PADLOCK TTLKRIP

Security level



## Technical Data

- Steel lock body with stainless steel cover , hardened-steel shackle with chrome plated.
- Brass cylinder.  
3 nickel plated steel keys.

## Usage



## Technology



Product Number	SIZE (mm)	Shackle and lock body dimensions (mm)					
		A	B	C	D	E	F
<b>Short Shankle</b>							
TTLKRIP50	50	51	38	10.6	14	7.8	15
TTLKRIP60	60	60	38	10.6	20	7.8	15
TTLKRIP75	75	75	50	14.6	25	11.8	18
TTLKRIP90	90	90	60	19.6	36	11.8	20

# RECTANGLE TYPE IRON PADLOCK TTLKLIPA

Security level



## Technical Data

- Iron lock body with stainless steel cover , hardened-steel shackle with chrome plated.
- Brass cylinder.
- 3 nickel plated steel keys.

## Usage



## Technology



Product Number	SIZE (mm)	Shackle and lock body dimensions (mm)					
		A	B	C	D	E	F
<b>Short Shankle</b>							
TTLKLIPA50	50	51	38	10.6	14	7.8	15
TTLKLIPA60	60	60	38	10.6	20	7.8	15
TTLKLIPA75	75	75	50	14.6	25	11.8	18
TTLKLIPA90	90	90	60	19.6	36	11.8	20

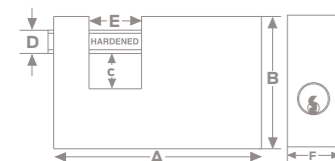

# RECTANGLE TYPE IRON PADLOCK TTLKLIPB

Security level



## Technical Data

- Iron lock body with stainless steel cover , hardened-steel shackle with chrome plated.
- Brass cylinder.
- 3 nickel plated steel keys.

## Usage



## Technology



Product Number	SIZE (mm)	Shackle and lock body dimensions (mm)					
		A	B	C	D	E	F
<b>Short Shankle</b>							
TTLKLIPB50	50	51	38	10.6	14	7.8	15
TTLKLIPB60	60	60	38	10.6	20	7.8	15
TTLKLIPB75	75	75	50	14.6	25	11.8	18
TTLKLIPB90	90	90	60	19.6	36	11.8	20

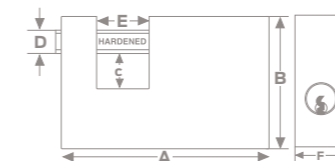

# ROUND SHAPE STAINLESS STEEL PADLOCK TTLKRSK70-1

Security level



## Technical Data

- Brass lock body , hardened-steel shackle with chrome plated.
- Brass cylinder.
- 3 nickel plated steel keys.

## Usage



## Technology

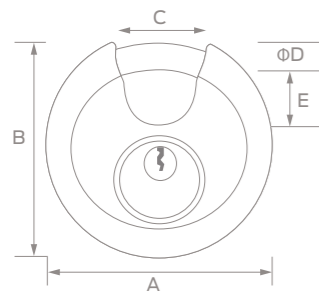

Product Number	SIZE (mm)	Shackle and lock body dimensions (mm)					
		A	B	C	D	E	F
<b>Short Shankle</b>							
TTLKRSK70-1	70	70	70	25	9.5	16.5	-

# ROUND SHAPE STAINLESS STEEL PADLOCK TTLKRSK70-2

Security level



## Technical Data

- Brass lock body , hardened-steel shackle with chrome plated.
- Brass cylinder.
- 3 nickel plated steel keys.

## Usage



## Technology

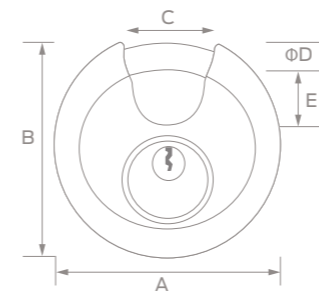

Product Number	SIZE (mm)	Shackle and lock body dimensions (mm)					
		A	B	C	D	E	F
<b>Short Shankle</b>							
TTLKRSK70-2	70	70	70	25	9.5	16.5	-

# COMBINATION DISC PADLOCK FOR OUTDOOR RSC70

Security level



Technical Data

- Brass lock body , hardened-steel shackle with chrome plated.
- Brass cylinder.
- Combination code.

Usage



Technology

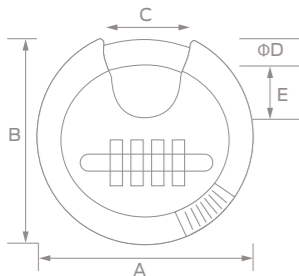

Product Number	SIZE (mm)	Shackle and lock body dimensions (mm)					
		A	B	C	D	E	F
<b>Short Shankle</b>							
RSC70	70	70	70	25	9.5	16.5	-

# COMBINATION DISC PADLOCK FOR OUTDOOR RSCB70

Security level



Technical Data

- Brass lock body , hardened-steel shackle with chrome plated.
- Brass cylinder.
- Combination code.

Usage



Technology

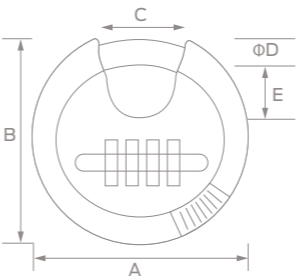

Product Number	SIZE (mm)	Shackle and lock body dimensions (mm)					
		A	B	C	D	E	F
<b>Short Shankle</b>							
RSCB70	70	70	70	25	9.5	16.5	-

# ANTI-THEFT ZAMAC COMBINATION PADLOCK AZAC50

Security level



## Technical Data

- Zinc Alloy lock body , hardened-steel shackle with chrome plated.
- 4 Zinc Alloy wheels.

## Usage



## Technology

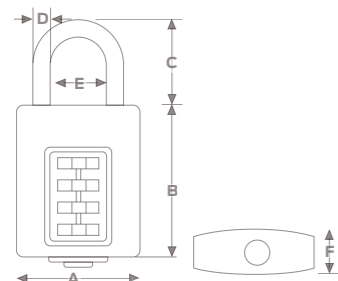

Product Number	SIZE (mm)	Shackle and lock body dimensions (mm)					
		A	B	C	D	E	F
<b>Short Shankle</b>							
AZAC50	50	50	60	40	7.5	24	18

# BRASS PADLOCK TTLKBPR

Security level

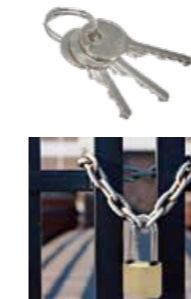

## Technical Data

- Brass lock body , hardened-steel shackle with chrome plated.
- Brass cylinder.
- 3 nickel plated steel keys.
- 2 waterproof rings.

## Usage



## Keyed Alike Available

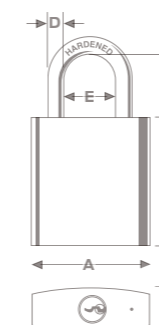
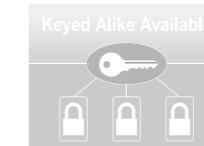

Product Number	SIZE (mm)	Shackle and lock body dimensions (mm)					
		A	B	C	D	E	F
<b>Short Shankle</b>							
TTLKBPR20	25	25	38	14.5	4	12.5	12
TTLKBPR40	40	38	33	20.5	6	20	16
TTLKBPR50	50	50	50	26	8.5	25.5	22
TTLKBPR60	60	62	50	32	10	31	25
<b>Long Shankle</b>							
TTLKBPR40L	40	38	33	65	6	20	16
TTLKBPR50L	50	50	42	72	8.5	25.5	22
TTLKBPR60L	60	63	50	77	10	31	25
TTLKBPR70L	75	74	58	78	10.8	40.5	26

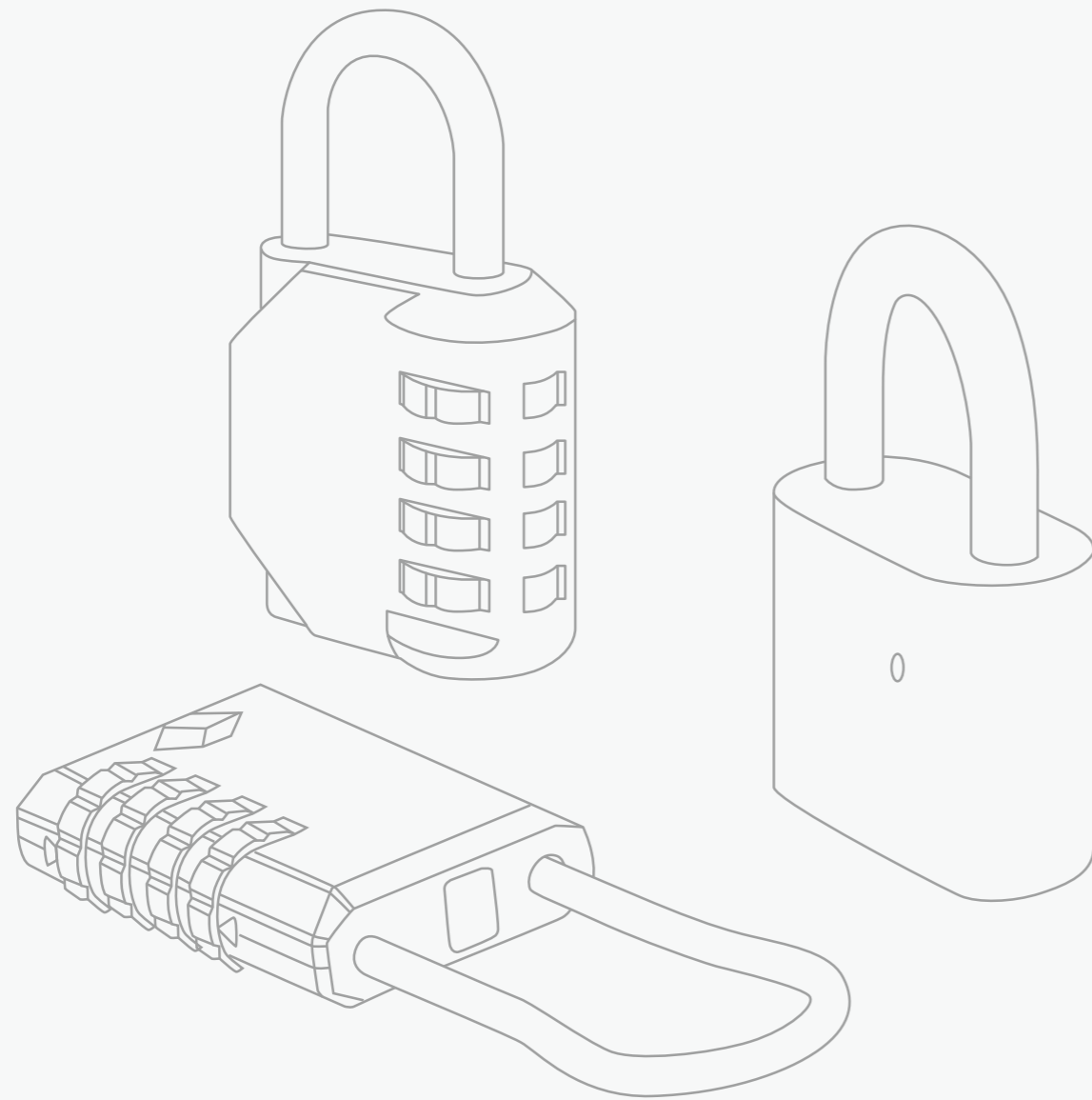

# CATALOG



# BRASS COMBINATION PADLOCK TTLKBC3/TTLKBC4

Security level



## Technical Data

- Brass lock body ,  
Steel shackle.
- 3 brass dials
- Suggested uses:  
Large lock: sheds, gates, storage lockers  
Small lock: luggage, cabinets

## Usage



## Technology

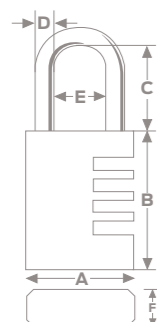

Product Number	SIZE (mm)	Shackle and lock body dimensions (mm)					
		A	B	C	D	E	F
<b>3 brass wheels</b>							
TTLKBC3-001	20*3	21	30	22.5	3	9	10
TTLKBC3-002	28*3	28	41.5	26	5	12.8	12
<b>4 brass wheels</b>							
TTLKBC4-003	20*4	21	35	22.5	3	9	10
TTLKBC4-004	28*4	28	48	26	5	12.8	12
TTLKBC4-005	38*4	38	49	30.2	6.3	19	13
TTLKBC4-006	--	50	52	42	8	26	15

# ALUMINUM COMBINATION PADLOCK TTLKAC3/TTLKAC4

Security level



## Technical Data

- Aluminum lock body ,  
Stainless steel with chrome plated.
- Steel shackle
- 3/4 brass dials Suggested uses:  
Large lock: sheds, gates, storage lockers  
Small lock: luggage, cabinets

## Usage



## Technology

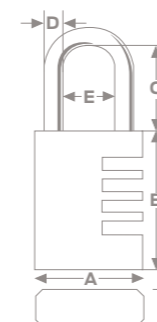

Product Number	SIZE (mm)	Shackle and lock body dimensions (mm)					
		A	B	C	D	E	F
<b>3 brass wheels</b>							
TTLKAC3-001	20*3	21	30	20.8	3.2	8.8	10
TTLKAC3-002	30*3	28.5	41.2	26.3	5	12.8	12.5
<b>4 brass wheels</b>							
TTLKAC4-003	20*4	21	36	21.8	3.2	8.8	10
TTLKAC4-004	30*4	28.5	46	25.5	5	12.4	12.5
TTLKAC4-005	40*4	38	49.7	30.5	6.3	18.7	13

# ALUMINUM COMBINATION PADLOCK TTLKRAC108

Security level



## Technical Data

- Aluminum alloy lock body different colors painted available, Steel shackle.
- 3 aluminium alloy dials.

## Usage



## Technology

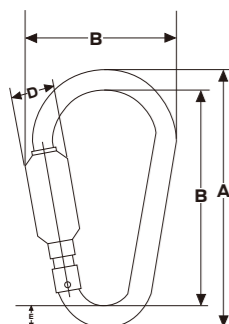

Product Number	SIZE (mm)	Shackle and lock body dimensions (mm)					
		A	B	C	D	E	F
TTLKRAC108	-	108.5	91.1	64.2	18.2	9	-

# ROUND SHAPE ZAMAC COMBINATION PADLOCK TTLKRSZACP30

Security level



## Technical Data

- Zinc alloy lock body, different colors painted available
- Steel cable
- Zinc alloy dials
- Available for luggage

## Usage



## Technology

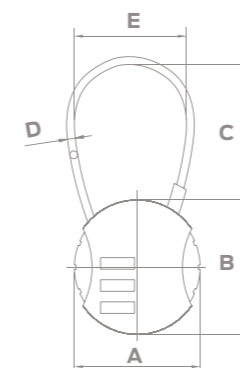

Product Number	SIZE (mm)	Shackle and lock body dimensions (mm)					
		A	B	C	D	E	F
TTLKRSZACP30	-	37	39.6	40	2.3	33	-

# ZAMAC COMBINATION PADLOCK TTLKZAC

Security level



3 wheels

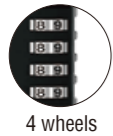

4 wheels



## Technical Data

- Zinc Alloy lock body ,
- Stainless steel with chrome plated.
- 3 or 4 Zinc Alloy wheels.

## Usage



## Technology

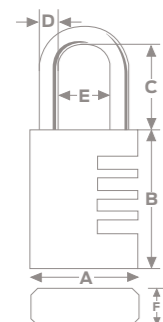

Product Number	SIZE (mm)	Shackle and lock body dimensions (mm)					
		A	B	C	D	E	F
TTLKZAC30	30	32.5	56.5	25	6	18.75	12.5
TTLKZAC40	40	43	52	26	6	20	20

# ZAMAC COMBINATION PADLOCK ZACR40

Security level



## Technical Data

- Zinc Alloy lock body ,
- Stainless steel with chrome plated.
- 4 Zinc Alloy wheels.

## Usage



## Technology

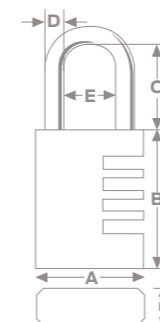
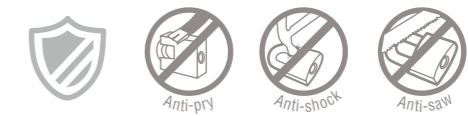

Product Number	SIZE (mm)	Shackle and lock body dimensions (mm)					
		A	B	C	D	E	F
<b>Short Shankle</b>							
ZACR40	40	44	50.7	25.8	6	21	18
<b>Long Shankle</b>							
ZACR40L	40	44	50.7	50	6	21	18

# ZAMAC COMBINATION PADLOCK ZACA40

Security level



## Technical Data

- Zinc Alloy lock body ,
- Stainless steel with chrome plated.
- 4 Zinc Alloy wheels.

## Usage



## Technology

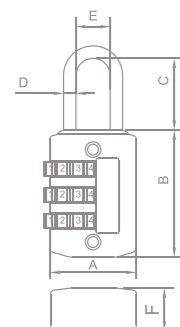

Product Number	SIZE (mm)	Shackle and lock body dimensions (mm)					
		A	B	C	D	E	F
ZACA40	30	30	66.5	23.5	3.2	8.8	14

# ZAMAC COMBINATION PADLOCK ZACR40

Security level

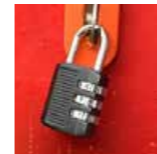

## Technical Data

- Zinc Alloy lock body ,
- Stainless steel with chrome plated.
- 3 Zinc Alloy wheels.

## Usage



## Technology

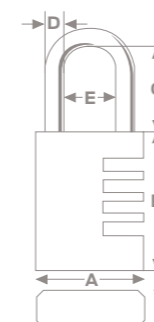

Product Number	SIZE (mm)	Shackle and lock body dimensions (mm)					
		A	B	C	D	E	F
TTLKZAC30	20	22.1	31.7	19.5	3.2	8.8	11
TTLKZAC40	30	31.2	37.3	20.4	4.8	14	13

# ZAMAC COMBINATION PADLOCK TTLKRAC2

Security level



## Technical Data

- Zinc alloy lock body, different colors painted available
- Zinc alloy dials
- Zinc alloy button
- Available for luggage

## Usage



## Technology



Product Number	SIZE (mm)	Shackle and lock body dimensions (mm)					
		A	B	C	D	E	F
TTLKRAC2	20	20.8	38	18.1	3	9	-

# ZAMAC COMBINATION PADLOCK TTLKRAC3

Security level



## Technical Data

- Zinc alloy lock body, different colors painted available
- Zinc alloy dials
- Zinc alloy button
- Available for luggage

## Usage



## Technology

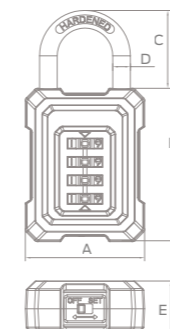

Product Number	SIZE (mm)	Shackle and lock body dimensions (mm)					
		A	B	C	D	E	F
TTLKRAC3	50	47.3	91.3	30.85	7	22	-

# ZAMAC COMBINATION PADLOCK TTLKRAC1

Security level



## Technical Data

- Zinc alloy lock body, different colors painted available
- Zinc alloy dials
- Zinc alloy button
- Available for luggage

## Usage



## Technology

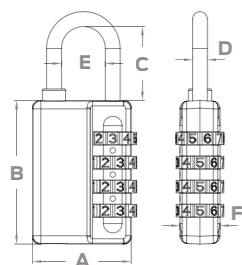

Product Number	SIZE (mm)	Shackle and lock body dimensions (mm)					
		A	B	C	D	E	F
TTLKRAC1	29	29	41	20.5	4	12.5	12
TTLKRAC1	32	32	46.5	24	4.8	14.2	13

# ZAMAC COMBINATION PADLOCK TTLKMH21305

Security level



## Technical Data

- Use the lock to lock the backpack with the armrests of the seats in public places (such as airports) and the luggage rack above the high-speed rail seats, which can provide a care function in a short time to avoid luggage loss.
- Use the wire rope of the lock to string multiple zipper pieces on the backpack at the same time and lock it to avoid the backpack being opened in public places where people gather.

## Usage



## Technology

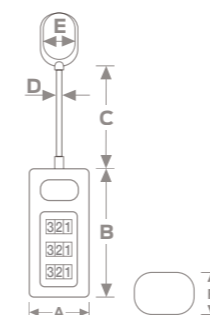

Product Number	SIZE (mm)	Shackle and lock body dimensions (mm)					
		A	B	C	D	E	F
TTLKMH21305	20	20	42	54.7	3	-	16

# ZAMAC COMBINATION PADLOCK TTLK-ZCP

Security level



# ZAMAC COMBINATION PADLOCK TTLK-ZCP50

Security level

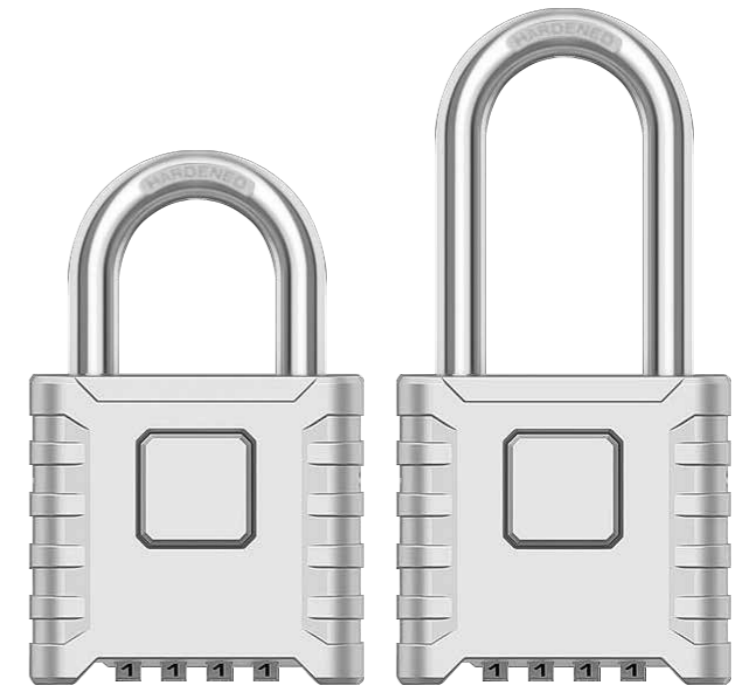

## Technical Data

- Zinc Alloy lock body ,  
Hardened-steel shackle.
- Zinc alloy dials
- Zinc alloy button
- Available for luggage

## Usage



## Technology

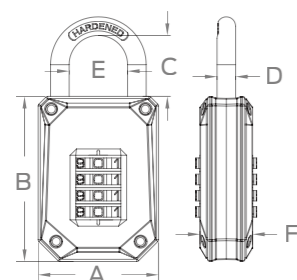

Product Number	SIZE (mm)	Shackle and lock body dimensions (mm)					
		A	B	C	D	E	F
TTLK-ZCPA	45	45.3	62.1	22.9	7	22	19.8
TTLK-ZCPB	45	45.3	62.1	50	7	22	19.8

## Technical Data

- Zinc Alloy lock body ,  
Hardened-steel shackle.
- Zinc alloy dials
- Zinc alloy button
- Available for luggage

## Usage



## Technology

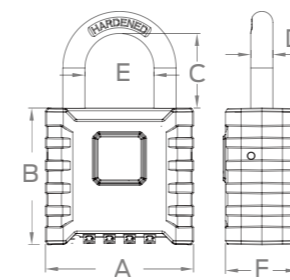

Product Number	SIZE (mm)	Shackle and lock body dimensions (mm)					
		A	B	C	D	E	F
TTLK-ZCP50	50	53.6	49.5	27	8	25	26.3

# ZAMAC COMBINATION PADLOCK TTLKRAC4

Security level



## Technical Data

- Zinc alloy lock body
- Stainless steel combination wheel
- Stainless steel shackle
- Stainless steel button

## Usage



## Technology

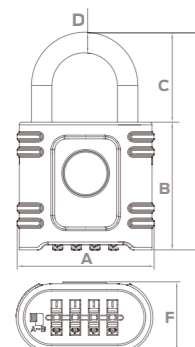

Product Number	SIZE (mm)	Shackle and lock body dimensions (mm)					
		A	B	C	D	E	F
TTLKRAC4	-	53.6	50	35	8	-	27.3

# ZAMAC COMBINATION PADLOCK TTLKRAC5

Security level



## Technical Data

- Zinc alloy lock body
- Stainless steel combination wheel
- Stainless steel shackle
- Stainless steel button

## Usage



## Technology

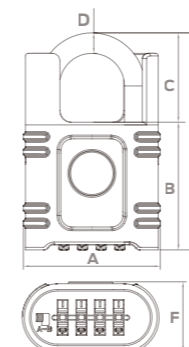

Product Number	SIZE (mm)	Shackle and lock body dimensions (mm)					
		A	B	C	D	E	F
TTLKRAC5	-	53.6	50	35	8	-	27.3

# SQUARE TYPE COLORFUL ZAMAC COMBINATION PADLOCK

Security level



## Technical Data

- Zinc alloy lock body, new process to form colorful shape
- Steel shackle
- 3 zinc alloy dials
- Beautiful cultural lock can be used as collection, gifts as well as luggage padlock

## Usage



## Technology

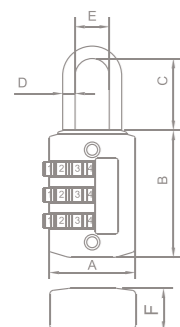

Product Number	SIZE (mm)	Shackle and lock body dimensions (mm)					
		A	B	C	D	E	F
TTLKZAC30	20	22.1	31.7	19.5	3.2	8.8	11
TTLKZAC40	30	31.2	37.3	20.4	4.8	14	13

# A TYPE H TYPE ZAMAC LUGGAGE PADLOCK

Security level



## Technical Data

- The padlock with protection of a strong vinyl cover.
- The vinyl cover is available in three attractive colors and provides protection, not only for the padlock, but also for the equipment being secured.
- The padlocks are therefore highly suitable for securing luggage, tool boxes, sports equipment and for many other uses.

## Usage



## Technology



Product Number	SIZE (mm)	Shackle and lock body dimensions (mm)					
		A	B	C	D	E	F
TTLK-HZLP50	50	50	45	19.5	8.8	21.5	23.5

# ZAMAC COMBINATION PADLOCK ZACL108

Security level

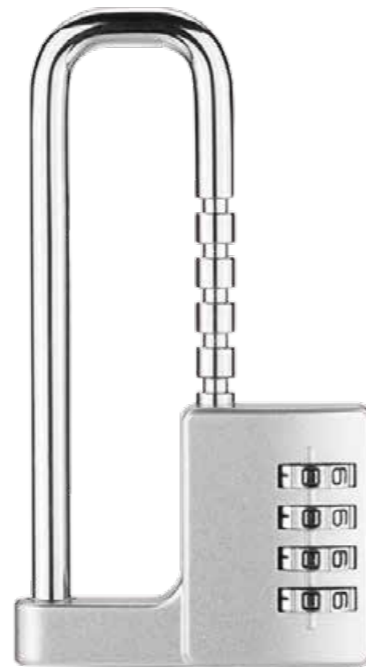

## Technical Data

- Zinc Alloy body ,Steel with chrome plated.
- 4 Zinc Alloy wheels.

## Usage



## Technology

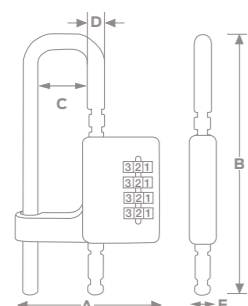

Product Number	SIZE (mm)	Shackle and lock body dimensions (mm)					
		A	B	C	D	E	F
ZACL108	-	108.5	91.1	64.2	18.2	9	-

# ZAMAC COMBINATION PADLOCK ZACR27

Security level



## Technical Data

- Zinc Alloy lock body , hardened-steel shackle.
- Zinc alloy code wheels. 3 digital combination.

## Usage



## Technology

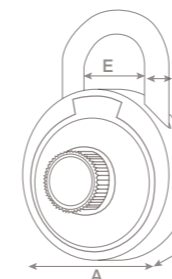

Product Number	SIZE (mm)	Shackle and lock body dimensions (mm)					
		A	B	C	D	E	F
ZACR27	-	27	-	-	3.2	16.4	15

# LAMINATED STEEL COMBINATION PADLOCK

Security level



## Technical Data

- Laminated steel lock body ,  
Hardened-steel shackle.
- Double-locking bolts with  
3 or 4 brass wheels.

## Usage



## Technology

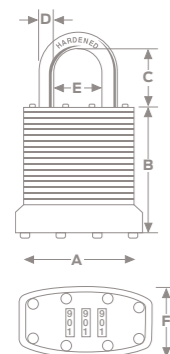

Product Number	SIZE (mm)	Shackle and lock body dimensions (mm)					
		A	B	C	D	E	F
TTLK-LSC45	45	45	26.8	23	7	25	27

# RETRACTABLE CABLE PADLOCK

Security level



## Technical Data

- Feature highlights: The Telescopic Steel Cable Lock is crafted from high-quality alloy steel, offering robust anti-theft protection for motorcycles, helmets, suitcases, and more. Its anti-peep code feature ensures security, while compatibility with multiple door types, including glass and wood, adds versatility. Certified for quality assurance, it provides compliance with safety standards and enhances market access.

## Usage



## Technology

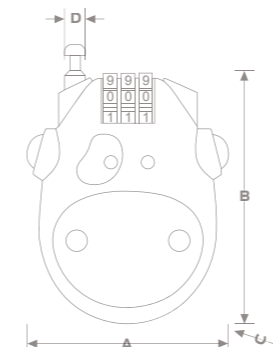

Product Number	SIZE (mm)	Shackle and lock body dimensions (mm)					
		A	B	C	D	E	F
TTLK-RCP56	56	56.7	78.3	22	7	-	-

# HEAVY-DUTY BRASS COMBINATION PADLOCK TTLKBC50

Security level



## Technical Data

- Brass body , hardened-steel shackle.
- Double-locking bolts with 4 brass wheels

## Usage



## Technology

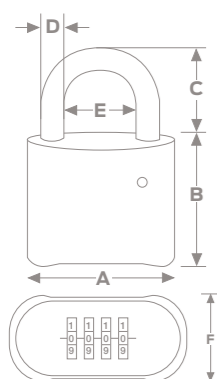

Product Number	SIZE (mm)	Shackle and lock body dimensions (mm)					
		A	B	C	D	E	F
<b>Brass combination padlock</b>							
TTLKBC50	50	53	40	25	7	25	25

# HEAVY-DUTY IRON COMBINATION PADLOCK TTLKICP50

Security level



## Technical Data

- Iron body , hardened-steel shackle.
- Double-locking bolts with 4 brass wheels

## Usage



## Technology

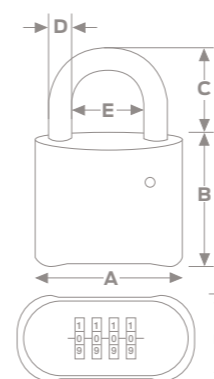

Product Number	SIZE (mm)	Shackle and lock body dimensions (mm)					
		A	B	C	D	E	F
<b>Iron combination padlock</b>							
TTLKICP50	50	53	40	25	7	25	25

# KEY TSA PADLOCK

Security level



## Technical Data

- Brass lock body
- ABC coat
- A3 steel shackle
- Brass cylinder

## Usage



## Technology

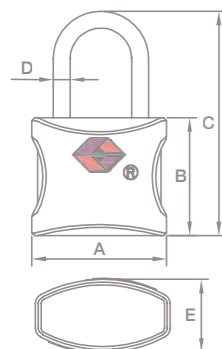

Product Number	SIZE (mm)	Shackle and lock body dimensions (mm)					
		A	B	C	D	E	F
ZACR30	20	24	21	40	3	13	-

# KEY TSA PADLOCK TTLK-TSAPC30

Security level



## Technical Data

- ABS lock body
- Plastic combination wheel
- Stainless steel lock rope
- Zinc alloy lock cylinder

## Usage



## Technology

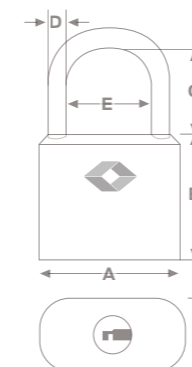

Product Number	SIZE (mm)	Shackle and lock body dimensions (mm)					
		A	B	C	D	E	F
TTLK-TSA326B-1	30	28.5	28.5	11.3	3.2	-	16.2

# TSA PADLOCK

Security level



## Technical Data

- Zinc Alloy body ,Steel with chrome plated.
- 4 Zinc Alloy wheels.

## Usage



## Technology

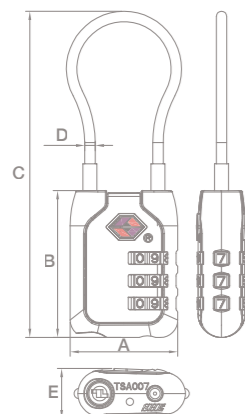

Product Number	SIZE (mm)	Shackle and lock body dimensions (mm)					
		A	B	C	D	E	F
ZACL30	30	30.8	42	82	3	14.3	-

# TSA PADLOCK

Security level



## Technical Data

- Zinc Alloy lock body , hardened-steel shackle.
- Zinc alloy code wheels. 3 digital combination.

## Usage



## Technology

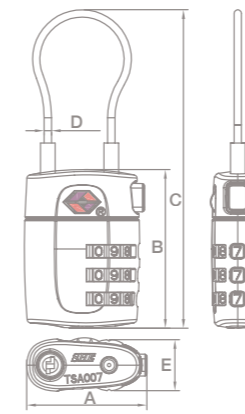

Product Number	SIZE (mm)	Shackle and lock body dimensions (mm)					
		A	B	C	D	E	F
ZACR30	30	32.85	43.35	83.5	3	14	-

# TSA PADLOCK

Security level



## Technical Data

- Zinc alloy lock body
- Plastic combination wheel
- A3 steel shackle
- Zinc alloy lock cylinder

## Usage



## Technology

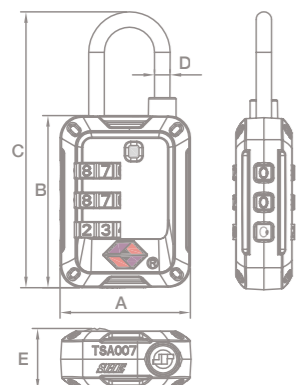

Product Number	SIZE (mm)	Shackle and lock body dimensions (mm)					
		A	B	C	D	E	F
ZACL30	30	29.5	39	62.5	3.5	14	-

# TSA PADLOCK

Security level



## Technical Data

- Zinc alloy lock body
- Plastic combination wheel
- A3 steel shackle
- Zinc alloy lock cylinder

## Usage



## Technology

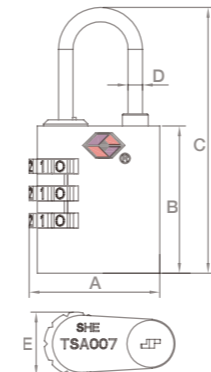

Product Number	SIZE (mm)	Shackle and lock body dimensions (mm)					
		A	B	C	D	E	F
ZACR30	30	32	36	65	3.5	15.5	-

# SPLIT-TYPE TSA PADLOCK

Security level



Technical Data

- Supplier highlights: This supplier is both a manufacturer and trader, exporting mainly to Canada, France, and Belgium. They boast high customer satisfaction with a positive review rate of 97.8%.
- Positive retail outlook: The product's high popularity in retail is underpinned by sustained high search volume and consistent top bestseller rankings.

Usage



Technology

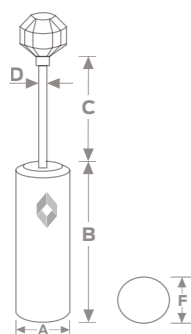

Product Number	SIZE (mm)	Shackle and lock body dimensions (mm)					
		A	B	C	D	E	F
STAP15	15	15.4	34.2	47	3	-	15.4

# SPLIT-TYPE TSA PADLOCK

Security level



Technical Data

- Supplier highlights: This supplier is both a manufacturer and trader, exporting mainly to the United States, Germany, and the Netherlands. With a positive review rate of 96.7%, they offer services such as full customization and design customization. Their key strengths include one-stop shop capabilities and quality control.

Usage



Technology

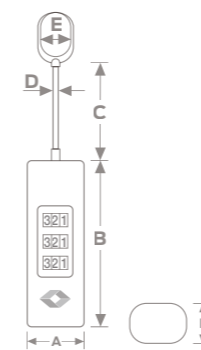

Product Number	SIZE (mm)	Shackle and lock body dimensions (mm)					
		A	B	C	D	E	F
STAP20	20	20	52	84	3	14	14

# TSA PADLOCK

Security level



## Technical Data

- ABS lock body
- Plastic combination wheel
- Stainless steel lock rope
- Zinc alloy lock cylinder

## Usage



## Technology

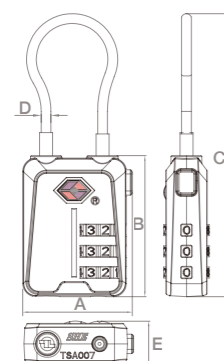

Product Number	SIZE (mm)	Shackle and lock body dimensions (mm)					
		A	B	C	D	E	F
ZACL30	30	33.8	43.3	84	3	14	-

# TSA PADLOCK

Security level



## Technical Data

- ABS lock body
- Plastic combination wheel
- A3 steel shackle
- Zinc alloy lock cylinder

## Usage



## Technology

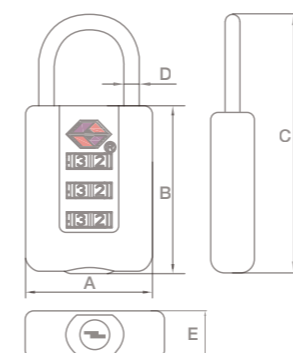

Product Number	SIZE (mm)	Shackle and lock body dimensions (mm)					
		A	B	C	D	E	F
ZACR30	30	30	45	70	3	13	-

# TSA PADLOCK

Security level



## Technical Data

- ABS lock body
- Plastic combination wheel
- A3 steel shackle
- Zinc alloy lock cylinder

## Usage



## Technology

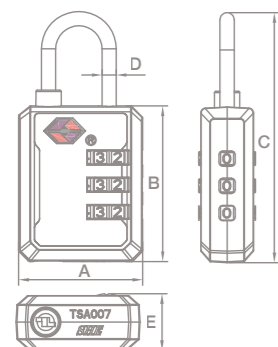

Product Number	SIZE (mm)	Shackle and lock body dimensions (mm)					
		A	B	C	D	E	F
ZACL30	30	30.5	38.3	61.5	3.5	14	-

# TSA PADLOCK TTLK-TSA30

Security level



## Technical Data

- Zinc Alloy body, steel shackle chrome plated.
- TSA customs lock.
- 3 Zinc Alloy wheels.

## Usage



## Technology

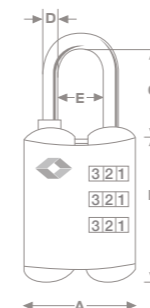

Product Number	SIZE (mm)	Shackle and lock body dimensions (mm)					
		A	B	C	D	E	F
TTLK-TSA30	30	30	40	20	3	10	-

# TSA PADLOCK TTLK-TSAB30

Security level



Technical Data

- Zinc Alloy body , steel shackle chrome plated.
- TSA customs lock.
- 3 Zinc Alloy wheels.

Usage



Technology

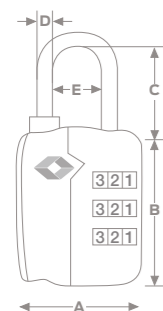

Product Number	SIZE (mm)	Shackle and lock body dimensions (mm)					
		A	B	C	D	E	F
TTLK-TSAB30	30	30	40	20	3	10	-

# TSA PADLOCK TTLK-TSARE30

Security level



Technical Data

- Zinc Alloy body , steel shackle chrome plated.
- TSA customs lock.
- 3 Zinc Alloy wheels.

Usage



Technology

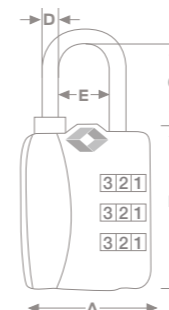

Product Number	SIZE (mm)	Shackle and lock body dimensions (mm)					
		A	B	C	D	E	F
TTLK-TSARE30	30	30	40	20	3	10	-

# TSA PADLOCK TTLK-TSAS

Security level

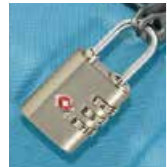

Technical Data

- Zinc Alloy body , steel shackle chrome plated.
- TSA customs lock.
- 3 Zinc Alloy wheels.

Usage



Technology

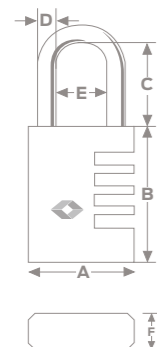

Product Number	SIZE (mm)	Shackle and lock body dimensions (mm)					
		A	B	C	D	E	F
TTLK-TSAS20	20	20	32.7	18.5	3.2	8.8	11
TTLK-TSAS30	30	30	37.3	20.4	4.8	14	13

# ROUND SHAPE ZINC ALLOY COMBINATION PADLOCK TTLK-TSAR42

Security level



Technical Data

- Zinc Alloy lock body different colors painted available , steel cable.
- TSA customs lock.
- 3 Plastic wheels.

Usage



Keyed Alike Available

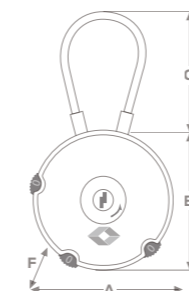

Product Number	SIZE (mm)	Shackle and lock body dimensions (mm)					
		A	B	C	D	E	F
TTLK-TSAR42	42	42	42	41	-	-	15

# PLASTIC COMBINATION PADLOCK

Security level



## Technical Data

- Plastic body , steel shackle.
- TSA customs lock.
- 3 Plastic wheels.

## Usage



## Technology

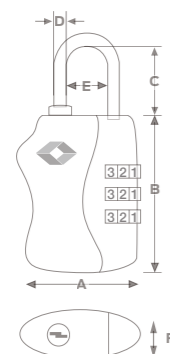

Product Number	SIZE (mm)	Shackle and lock body dimensions (mm)					
		A	B	C	D	E	F
TTLK-TSAP30	30	30	40	18	3	10	13

# PLASTIC COMBINATION PADLOCK TTLK-TSAFB40

Security level



## Technical Data

- Plastic body , Flexible shackle: steel cable with PVC cover.
- TSA customs lock.
- 3 Plastic wheels.

## Usage



## Technology

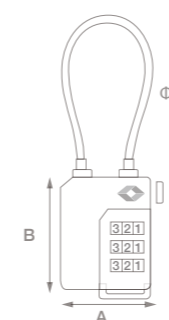

Product Number	SIZE (mm)	Shackle and lock body dimensions (mm)					
		A	B	C	D	E	F
TTLK-TSAFB40	-	40	30	-	3	-	-

# TSA PADLOCK TTLK-TSAF30

Security level



Technical Data

- Zinc Alloy body , Flexible shackle: steel cable with PVC cover.
- TSA customs lock.
- 3 Zinc Alloy wheels.

Usage



Technology

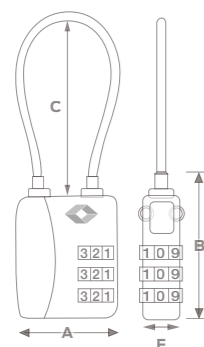

Product Number	SIZE (mm)	Shackle and lock body dimensions (mm)					
		A	B	C	D	E	F
TTLK-TSAF30	30	30	39	59	-	-	10.9

# TSA PADLOCK

Security level



Technical Data

- Eco-friendly plastic lock body
- Stainless steel lock rope
- Plastic combination wheel

Usage



Technology



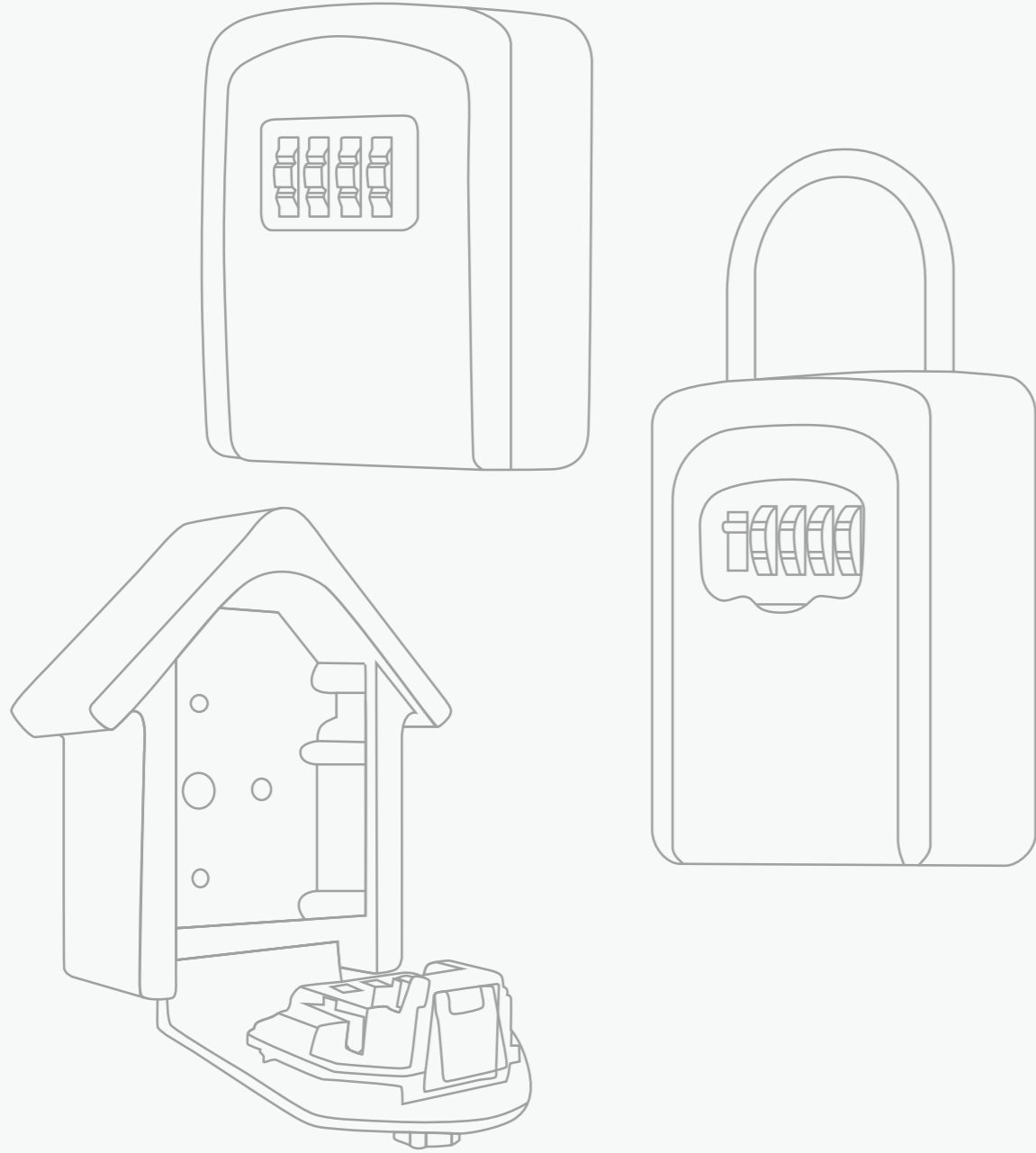

# CATALOG



## BOOK SAFE LOCK

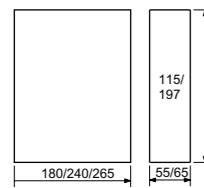

### Technical Data

- Lock Type : Key
- Material : Steel+crepe paper
- Color : Navy Black Red



Product Number	SIZE (mm)
TTLK-BSL001	180X115X55
TTLK-BSL002	240X115X55
TTLK-BSL003	265X197X65

## BOOK SAFE LOCK

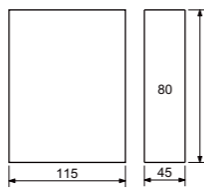
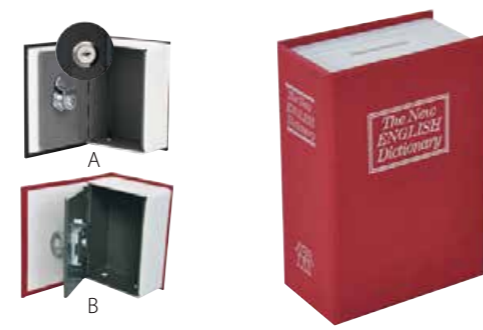

### Technical Data

- Lock Type : Key
- Material : Steel+crepe paper
- Color : Navy Black Red



Product Number	SIZE (mm)
TTLK-BSL004	115X80X45

## BOOK SAFE LOCK

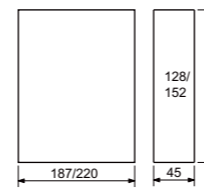

### Technical Data

- Lock Type : Key
- Material : Alloy Steel, Resin paper

Product Number	SIZE (mm)
TTLK-BSCL007	187X128X45
TTLK-BSCL008	220X152X45

## BOOK SAFE WITH COMBINATION LOCK

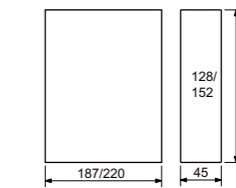

### Technical Data

- Lock Type : Combination
- Material : Alloy Steel, Resin paper

Product Number	SIZE (mm)
TTLK-BSCL009	187X128X45
TTLK-BSCL010	220X152X45

## BOOK SAFE WITH COMBINATION LOCK

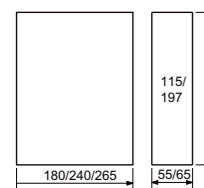
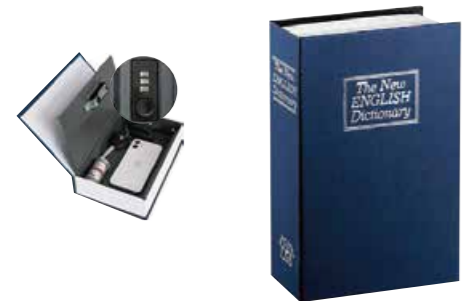

### Technical Data

- Lock Type : Combination
- Material : Steel+crepe paper
- Color : Navy Black Red



Product Number	SIZE (mm)
TTLK-BSCL001	180X115X55
TTLK-BSCL002	240X115X55
TTLK-BSCL003	265X197X65

## BOOK SAFE WITH COMBINATION LOCK

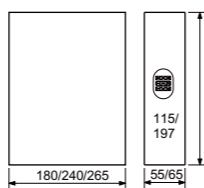

### Technical Data

- Lock Type : Combination
- Material : Steel+crepe paper
- Color : Navy Black Red



Product Number	SIZE (mm)
TTLK-BSCL004	180X115X55
TTLK-BSCL005	240X115X55
TTLK-BSCL006	265X197X65

## BOOK SAFE LOCK

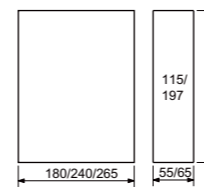

### Technical Data

- Lock Type : Key
- Material : Leather
- Color : Navy Black Red



Product Number	SIZE (mm)
TTLK-BSCL011	180X115X55
TTLK-BSCL012	240X115X55
TTLK-BSCL013	265X197X65

## BOOK SAFE WITH COMBINATION LOCK

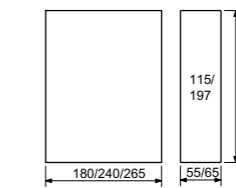

### Technical Data

- Lock Type : Combination
- Material : Leather
- Color : Navy Black Red



Product Number	SIZE (mm)
TTLK-BSCL014	180X115X55
TTLK-BSCL015	240X115X55
TTLK-BSCL016	265X197X65

## COMBINATION KEY SAFE LOCK TTLKG6

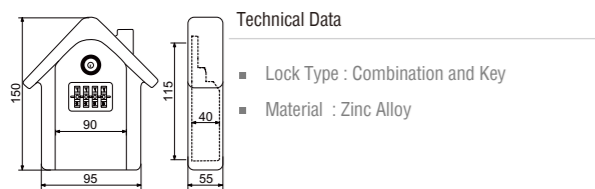

Product Number	SIZE (mm)
TTLK-G6	External 150X95X54 Internal 115X90X40

## COMBINATION KEY SAFE LOCK TTLKG9

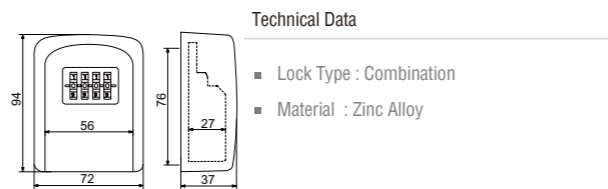

Product Number	SIZE (mm)
TTLK-G9	External 94X72X37 Internal 76X56X27

## COMBINATION KEY SAFE LOCK TTLKG7

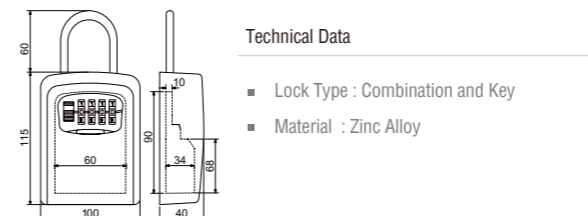

Product Number	SIZE (mm)
TTLK-G7	External 115X100X40 Internal 90X60X34

## COMBINATION KEY SAFE LOCK TTLKG10

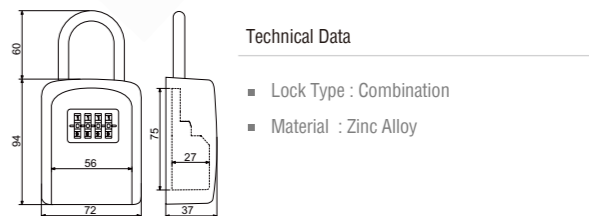

Number	SIZE (mm)
TTLK-G10	External 94X72X37 Internal 76X56X27

## COMBINATION KEY SAFE LOCK TTLKG3

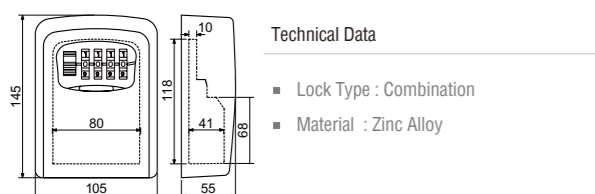

Product Number	SIZE (mm)
TTLK-G3	External 145X105X55 Internal 118X80X41

## COMBINATION KEY SAFE LOCK TTLKG3-2

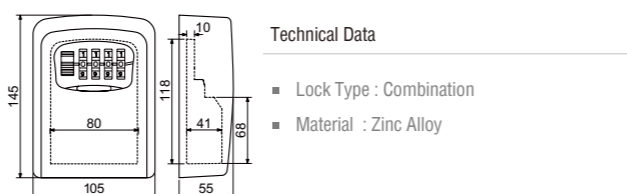

Product Number	SIZE (mm)
TTLK-G3-2	External 145X105X55 Internal 118X80X41

## COMBINATION KEY SAFE LOCK TTLKG10-2

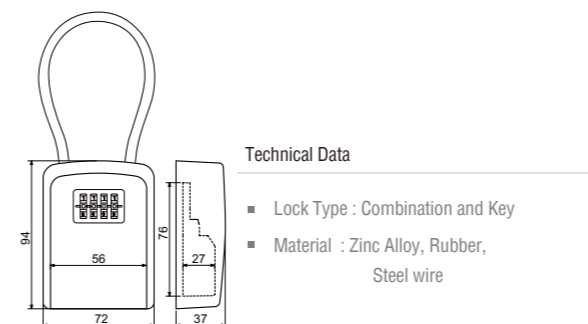

Product Number	SIZE (mm)
TTLK-G10-2	External 94X72X37 Internal 76X56X27

## COMBINATION KEY SAFE LOCK TTLKCKSL001

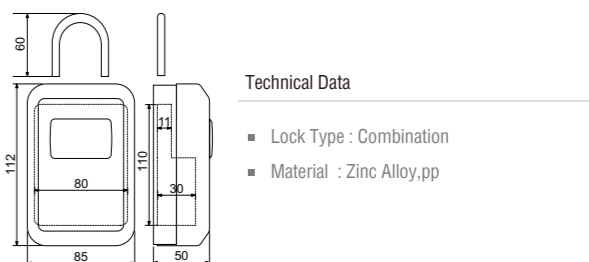

Product Number	SIZE (mm)
TTLK-CKSL001	External 112X85X50 Internal 110X80X30

TTLK-24025A

TTLK-24025B

## COMBINATION KEY SAFE LOCK TTLKG12

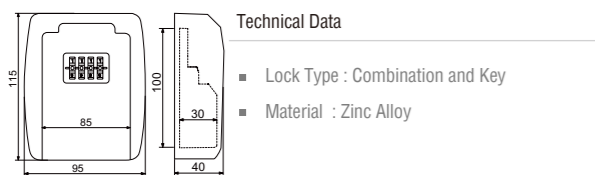

Product Number	SIZE (mm)
TTLK-G12	External 115X95X40 Internal 100X85X30

## COMBINATION KEY SAFE LOCK TTLKG2

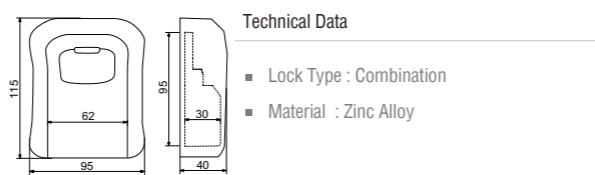

Product Number	SIZE (mm)
TTLK-G2	External 115X95X40 Internal 95X62X30

## COMBINATION KEY SAFE LOCK TTLKG4

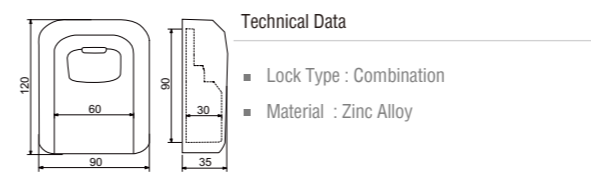

Product Number	SIZE (mm)
TTLK-G4	External 120X90X40 Internal 90X60X35

## COMBINATION KEY SAFE LOCK TTLKCKSL004

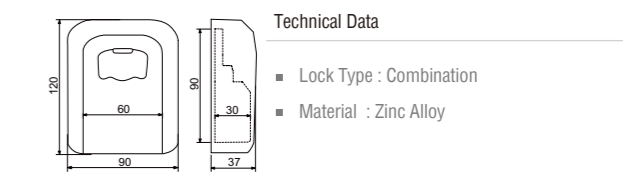

Product Number	SIZE (mm)
TTLK-G4	External 94X72X37 Internal 76X56X27

## COMBINATION KEY SAFE LOCK TTLKCKSL002

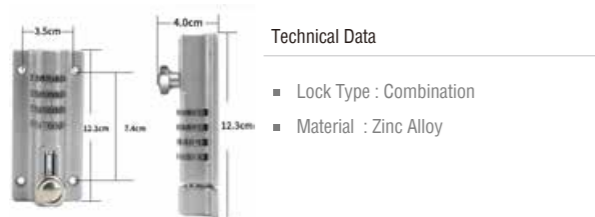

Product Number	SIZE (mm)
TTLK-CKSL002	123X40

## COMBINATION KEY SAFE LOCK TTLKCKSL003

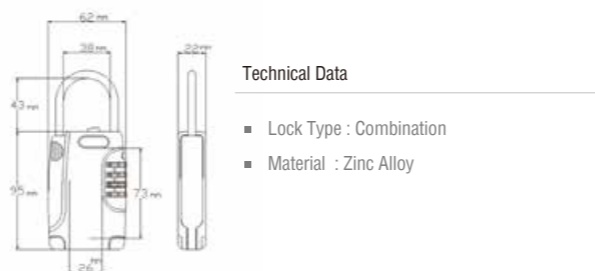

Product Number	SIZE (mm)
TTLK-CKSL003	External 138X62X22

## COMBINATION KEY SAFE LOCK TTLKCKSL005

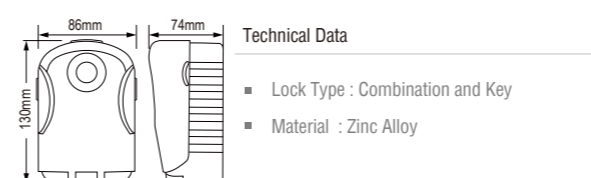

Product Number	SIZE (mm)
TTLK-CKSBS001	130X86X74

## COMBINATION KEY SAFE LOCK TTLKCKSL006



Product Number	SIZE (mm)
TTLK-CKSB002	240X140X58

## FOLDED BICYCLE LOCK (TTLK-BL85)



### Technical Data

- Folding Lock--flexibility in a compact design
- A transportation pouch or bracket is available
- Cylinder with anti-drill, anti-saw and anti-pick protection
- Corrosion protection
- Recommended for two-wheelers with a medium risk of theft.

Product Number	SIZE (mm)	PACKING
TTLKFBL85	56X24X145MM	Double Blister
TTLKFBL85	56X24X189MM	Double Blister



## FOLDED BICYCLE LOCK (TTLK-FBLA11)



### Technical Data

- Folding Lock--flexibility in a compact design
- A transportation pouch or bracket is available
- Cylinder with anti-drill, anti-saw and anti-pick protection
- Corrosion protection
- Recommended for two-wheelers with a medium risk of theft.

Product Number	SIZE (mm)	PACKING
TTLKFBLA11	35.5X30X26.5CM/12PCS	Double Blister

## FOLDED BICYCLE LOCK (TTLK-FBLA12)



### Technical Data

- Folding Lock--flexibility in a compact design
- A transportation pouch or bracket is available
- Cylinder with anti-drill, anti-saw and anti-pick protection
- Corrosion protection
- Recommended for two-wheelers with a medium risk of theft.

Product Number	SIZE (mm)	PACKING
TTLKFBLA12	850MM	Double Blister

## HANDCUFFS / SCOOTER LOCK (TTLK-BL001)

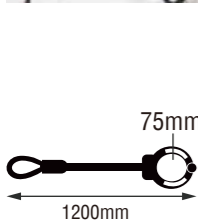

### Technical Data

- Bike lock has a hardened laminated steel construction with hardened pivot link that is virtually impossible to cut, plus it's compact design folds in half for convenient storage.
- For indoor and outdoor use; high security cuffs are best used for electric scooters and bikes with a parking meter, fence post, road sign poles or another bike

Product Number	SIZE (mm)	PACKING
TTLKBL001	75X1200MM	Tie On Card

## HANDCUFFS / SCOOTER LOCK (TTLK-BL002)



### Technical Data

- Bike lock has a hardened laminated steel construction with hardened pivot link that is virtually impossible to cut, plus it's compact design folds in half
- For indoor and outdoor use; high security cuffs are best used for electric scooters and bikes with a parking meter, fence post, road sign poles or another bike

Product Number	SIZE (mm)	PACKING
TTLKBL002	75X595MM	Tie On Card

## FOLDED BICYCLE LOCK (TTLK-FBLA13)

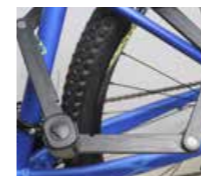

### Technical Data

- Folding Lock--flexibility in a compact design
- A transportation pouch or bracket is available
- Cylinder with anti-drill, anti-saw and anti-pick protection
- Corrosion protection
- Recommended for two-wheelers with a medium risk of theft.

Product Number	SIZE (mm)	PACKING
TTLKFBLA13a	1100MM	Double Blister
TTLKFBLA13b	1200MM	Double Blister

## FOLDED BICYCLE LOCK (TTLK-FBLA14)



### Technical Data

- Folding Lock--flexibility in a compact design
- A transportation pouch or bracket is available
- Cylinder with anti-drill, anti-saw and anti-pick protection
- Corrosion protection
- Recommended for two-wheelers with a medium risk of theft.

Product Number	SIZE (mm)	PACKING
TTLKFBLA14a	124x57x26mm	Double Blister
TTLKFBLA14b	190x60x30mm	Double Blister

## SILICON U LOCK (TTLK-SUL001)



### Technical Data

- Reset way
- Default code is 0-0-0-0
- Open the lock after push forward the opening ring
- Turn(reset)ring a 90° clockwise direction against the stop
- Turn the number wheel to your favourite number combination
- Push back (reset) ring to the starting position anti-clockwise direction.
- New code is set.
- Put the shackle to the lock body.

Product Number	SIZE (mm)	PACKING
TTLKSUL001	Φ12X175X210MM	Tie On Card

## SILICON U LOCK (TTLK-SUL002)



### Technical Data

- Integrated Silicon Molded Design: Easy-to-clean and won't scratch your bike
- Mounting Bracket System: Includes transportation bracket system for versatile carrying
- Fits easily into your back pocket, hang on handlebars or place in messenger bag/backpack

Product Number	SIZE (mm)	PACKING
TTLKSUL002	Φ12X162X270MM	Tie On Card

## U LOCK (TTLK-UL001)



### Technical Data

- Suitable for all two-wheeled vehicles: motorcycles, scooters, and bicycles.
- Also suitable for models where chain locks are not compatible.
- The protective shell with impact-resistant plastic protects against damage to the frame or paint.

Product Number	SIZE (mm)	PACKING
TTLKUL001	Φ12X175X250mm	Tie On Card

## U LOCK (TTLK-UL002)



### Technical Data

- Suitable for all two-wheeled vehicles: motorcycles, scooters, and bicycles.
- Also suitable for models where chain locks are not compatible.
- The protective shell with impact-resistant plastic protects against damage to the frame or paint.

Product Number	SIZE (mm)	PACKING
TTLKUL002	Φ14X170X260mm	Tie On Card

## SILICON U LOCK (TTLK-SUL003)



### Technical Data

- Integrated Silicon Molded Design: Easy-to-clean and won't scratch your bike
- Mounting Bracket System: Includes transportation bracket system for versatile carrying
- Fits easily into your back pocket, hang on handlebars or place in messenger bag/backpack

Product Number	SIZE (mm)	PACKING
TTLKSUL003A	Φ14X120X143MM	Tie On Card
TTLKSUL003B	Φ14X120X175MM	Tie On Card
TTLKSUL003C	Φ14X120X190MM	Tie On Card

## SILICON U LOCK (TTLK-SUL004)



### Technical Data

- Integrated Silicon Molded Design: Easy-to-clean and won't scratch your bike
- Mounting Bracket System: Includes transportation bracket system for versatile carrying
- Fits easily into your back pocket, hang on handlebars or place in messenger bag/backpack

Product Number	SIZE (mm)	PACKING
TTLKBL004	Φ14X120X190MM	Tie On Card

## U LOCK (TTLK-UL003)



### Technical Data

- Suitable for all two-wheeled vehicles: motorcycles, scooters, and bicycles.
- Also suitable for models where chain locks are not compatible.
- The protective shell with impact-resistant plastic protects against damage to the frame or paint.

Product Number	SIZE (mm)	PACKING
TTLKUL003	Φ12X165X247mm	Tie On Card

## U LOCK (TTLK-UL004)



### Technical Data

- Suitable for all two-wheeled vehicles: motorcycles, scooters, and bicycles.
- Also suitable for models where chain locks are not compatible.
- The protective shell with impact-resistant plastic protects against damage to the frame or paint.

Product Number	SIZE (mm)	PACKING
TTLKUL004	Φ14X155X235mm	Tie On Card

## U LOCK (TTLK-UL005)



### Technical Data

- Suitable for all two-wheeled vehicles: motorcycles, scooters, and bicycles.
- Also suitable for models where chain locks are not compatible.
- The protective shell with impact-resistant plastic protects against damage to the frame or paint.



Product Number	SIZE (mm)	PACKING
TTLKUL005	Φ14X140X200mm	Tie On Card

## U LOCK (TTLK-UL006)



### Technical Data

- Suitable for all two-wheeled vehicles: motorcycles, scooters, and bicycles.
- Also suitable for models where chain locks are not compatible.
- The protective shell with impact-resistant plastic protects against damage to the frame or paint.



Product Number	SIZE (mm)	PACKING
TTLKUL006	Φ12X170X300mm	Tie On Card

## U LOCK (TTLK-UL009)



### Technical Data

- Suitable for all two-wheeled vehicles: motorcycles, scooters, and bicycles.
- Also suitable for models where chain locks are not compatible.
- The protective shell with impact-resistant plastic protects against damage to the frame or paint.



Product Number	SIZE (mm)	PACKING
TTLKUL009	Φ14.5X96X330mm	Tie On Card

## U LOCK (TTLK-UL010)



### Technical Data

- Suitable for all two-wheeled vehicles: motorcycles, scooters, and bicycles.
- Also suitable for models where chain locks are not compatible.
- The protective shell with impact-resistant plastic protects against damage to the frame or paint.



Product Number	SIZE (mm)	PACKING
TTLKUL010A	170X245mm	Tie On Card
TTLKUL010B	170X320mm	Tie On Card

## U LOCK (TTLK-UL007)



### Technical Data

- Suitable for all two-wheeled vehicles: motorcycles, scooters, and bicycles.
- Also suitable for models where chain locks are not compatible.
- The protective shell with impact-resistant plastic protects against damage to the frame or paint.



Product Number	SIZE (mm)	PACKING
TTLKUL007	Φ12X140X210mm	Tie On Card

## U LOCK (TTLK-UL008)



### Technical Data

- Suitable for all two-wheeled vehicles: motorcycles, scooters, and bicycles.
- Also suitable for models where chain locks are not compatible.
- The protective shell with impact-resistant plastic protects against damage to the frame or paint.



Product Number	SIZE (mm)	PACKING
TTLKUL008	Φ12X130X210mm	Tie On Card

## U LOCK (TTLK-UL011)

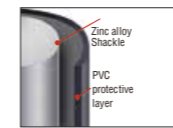

### Technical Data

- Suitable for all two-wheeled vehicles: motorcycles, scooters, and bicycles.
- Also suitable for models where chain locks are not compatible.
- The protective shell with impact-resistant plastic protects against damage to the frame or paint.



Product Number	SIZE (mm)	PACKING
TTLKUL011	Φ16X142X200mm	Tie On Card

## U LOCK (TTLK-UL012)

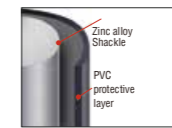

### Technical Data

- Suitable for all two-wheeled vehicles: motorcycles, scooters, and bicycles.
- Also suitable for models where chain locks are not compatible.
- The protective shell with impact-resistant plastic protects against damage to the frame or paint.



Product Number	SIZE (mm)	PACKING
TTLKUL012	Φ14.3X165X250mm	Tie On Card

## U LOCK (TTLK-UL013)



### Technical Data

- Suitable for all two-wheeled vehicles: motorcycles, scooters, and bicycles.
- Also suitable for models where chain locks are not compatible.
- The protective shell with impact-resistant plastic protects against damage to the frame or paint.

Product Number	SIZE (mm)	PACKING
TTLKUL013	Φ14.3X96X110mm	Tie On Card

## U LOCK (TTLK-UL014)



### Technical Data

- Suitable for all two-wheeled vehicles: motorcycles, scooters, and bicycles.
- Also suitable for models where chain locks are not compatible.
- The protective shell with impact-resistant plastic protects against damage to the frame or paint.

Product Number	SIZE (mm)	PACKING
TTLKUL014	Φ14.5X165X257mm	Tie On Card

## U LOCK (TTLK-UL017)



### Technical Data

- Suitable for scooters, bicycles, motorcycles, electric bicycles, tricycles, doors, grilles, stairs, etc.

Product Number	SIZE (mm)	PACKING
TTLKUL017	Φ10X95X103mm	Tie On Card

## U LOCK (TTLK-UL018)



### Technical Data

- Suitable for scooters, bicycles, motorcycles, electric bicycles, tricycles, doors, grilles, stairs, etc.

Product Number	SIZE (mm)	PACKING
TTLKUL018A	Φ12X95X103mm	Tie On Card
TTLKUL018B	Φ12X115X170mm	Tie On Card

## U LOCK (TTLK-UL015)

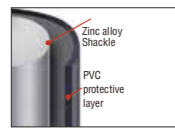

### Technical Data

- Suitable for all two-wheeled vehicles: motorcycles, scooters, and bicycles.
- Also suitable for models where chain locks are not compatible.
- The protective shell with impact-resistant plastic protects against damage to the frame or paint.

Product Number	SIZE (mm)	PACKING
TTLKUL015	Φ13X135X205mm	Tie On Card

## U LOCK (TTLK-UL016)

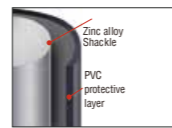

### Technical Data

- Suitable for all two-wheeled vehicles: motorcycles, scooters, and bicycles.
- Also suitable for models where chain locks are not compatible.
- The protective shell with impact-resistant plastic protects against damage to the frame or paint.

Product Number	SIZE (mm)	PACKING
TTLKUL016A	Φ16.5X100X100mm	Tie On Card
TTLKUL016B	Φ19.5X175X230mm	Tie On Card
TTLKUL016C	Φ19.5X175X320mm	Tie On Card

## U LOCK (TTLK-UL019)



### Technical Data

- U-shaped combination lock, 4-digit combination, suitable for bicycles, motorcycles and bicycle wheels, adjustable combination lock, with long lock hook, suitable for extended glass doors and motorcycle wheels.

Product Number	SIZE (mm)	PACKING
TTLKUL019	Φ16.5X110X440mm	Tie On Card

## U LOCK (TTLK-UL020)

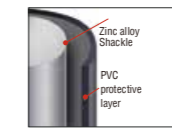

### Technical Data

- U-shaped combination lock, 5-digit combination, suitable for bicycles, motorcycles and bicycle wheels, adjustable combination lock, with long lock hook, suitable for extended glass doors and motorcycle wheels.

Product Number	SIZE (mm)	PACKING
TTLKUL020	Φ14X118X430mm	Tie On Card

## JOINT KEY LOCK (TTLK-JKL001)



### Technical Data

- Joint key Lock With Keyed lock, specially designed as a flexible lock that is extra secure and very tough to break.
- This lock is ideal to lock up a bike, a ladder, construction equipment, and many other applications.

Product Number	SIZE (mm)	PACKING
TTLKJKL001	Φ10X95X103mm	Tie On Card

## JOINT KEY LOCK (TTLK-JKL002)



### Technical Data

- Joint key Lock With Keyed lock, specially designed as a flexible lock that is extra secure and very tough to break.
- This lock is ideal to lock up a bike, a ladder, construction equipment, and many other applications.

Product Number	SIZE (mm)	PACKING
TTLKJKL002A	Φ12X95X103mm	Tie On Card
TTLKJKL002B	Φ12X115X170mm	Tie On Card

## JOINT KEY LOCK (TTLK-JKL005)



### Technical Data

- Joint key Lock With Keyed lock, specially designed as a flexible lock that is extra secure and very tough to break.
- This lock is ideal to lock up a bike, a ladder, construction equipment, and many other applications.

Product Number	SIZE (mm)	PACKING
TTLJKL005A	Φ18X800MM	Bound Card
TTLJKL005B	Φ18X1000MM	Bound Card
TTLJKL005C	Φ18X1200MM	Bound Card
TTLJKL005D	Φ18X1500MM	Bound Card

## JOINT KEY LOCK (TTLK-JKL006)



### Technical Data

- Joint key Lock With Keyed lock, specially designed as a flexible lock that is extra secure and very tough to break.
- This lock is ideal to lock up a bike, a ladder, construction equipment, and many other applications.

Product Number	SIZE (mm)	PACKING
TTLJKL006	Φ10X1500MM	Bound Card

## JOINT KEY LOCK (TTLK-JKL003)



### Technical Data

- Joint key Lock With Keyed lock, specially designed as a flexible lock that is extra secure and very tough to break.
- This lock is ideal to lock up a bike, a ladder, construction equipment, and many other applications.

Product Number	SIZE (mm)	PACKING
TTLJKL003A	Φ22X800MM	Bound Card
TTLJKL003B	Φ22X1000MM	Bound Card
TTLJKL003C	Φ22X1200MM	Bound Card
TTLJKL003D	Φ22X1500MM	Bound Card

## JOINT KEY LOCK (TTLK-JKL004)



### Technical Data

- Joint key Lock With Keyed lock, specially designed as a flexible lock that is extra secure and very tough to break.
- This lock is ideal to lock up a bike, a ladder, construction equipment, and many other applications.

Product Number	SIZE (mm)	PACKING
TTLJKL004A	Φ22X800MM	Bound Card
TTLJKL004B	Φ22X1000MM	Bound Card
TTLJKL004C	Φ22X1200MM	Bound Card
TTLJKL004D	Φ22X1500MM	Bound Card

## JOINT KEY LOCK (TTLK-JKL007)



### Technical Data

- Joint key Lock With Keyed lock, specially designed as a flexible lock that is extra secure and very tough to break.
- This lock is ideal to lock up a bike, a ladder, construction equipment, and many other applications.

Product Number	SIZE (mm)	PACKING
TTLJKL007A	Φ18X800MM	Bound Card
TTLJKL007B	Φ18X1000MM	Bound Card
TTLJKL007C	Φ18X1200MM	Bound Card
TTLJKL007D	Φ18X1500MM	Bound Card

## JOINT KEY LOCK (TTLK-JKL008)

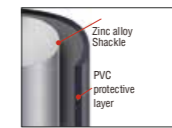

### Technical Data

- Joint key Lock With Keyed lock, specially designed as a flexible lock that is extra secure and very tough to break.
- This lock is ideal to lock up a bike, a ladder, construction equipment, and many other applications.

Product Number	SIZE (mm)	PACKING
TTLJKL008A	Φ18X800MM	Bound Card
TTLJKL008B	Φ18X1000MM	Bound Card
TTLJKL008C	Φ18X1200MM	Bound Card
TTLJKL008D	Φ18X1500MM	Bound Card

## JOINT KEY LOCK (TTLK-JKL009)



### Technical Data

- Joint key Lock With Keyed lock, specially designed as a flexible lock that is extra secure and very tough to break.
- This lock is ideal to lock up a bike, a ladder, construction equipment, and many other applications.



Product Number	SIZE (mm)	PACKING
TTLJKL009	Φ22X1000mm	Tie On Card

## JOINT KEY LOCK (TTLK-JKL010)



### Technical Data

- Joint key Lock With Keyed lock, specially designed as a flexible lock that is extra secure and very tough to break.
- This lock is ideal to lock up a bike, a ladder, construction equipment, and many other applications.



Product Number	SIZE (mm)	PACKING
TTLJKL010	Φ22X1000mm	Tie On Card

## JOINT COMBINATION LOCK (TTLK-JCL001)



### Technical Data

- 5-digit resettable code offering 100,000 combinations.
- The combination design is convenient to use and well suited for the use by several users.
- Available in different lengths.
- Set your own combination as often as you like.
- You can lock your bike/motorcycle by itself, or attach it to a fixed object (e. g. fence, lamppost, road sign.....)



Product Number	SIZE (mm)	PACKING
TTLKJCL001A	Φ18X800MM	Bound Card
TTLKJCL001B	Φ18X1000MM	Bound Card

## JOINT COMBINATION LOCK (TTLK-JCL002)



### Technical Data

- 5-digit resettable code offering 100,000 combinations.
- The combination design is convenient to use and well suited for the use by several users.
- Available in different lengths.
- Set your own combination as often as you like.
- You can lock your bike/motorcycle by itself, or attach it to a fixed object (e. g. fence, lamppost, road sign.....)



Product Number	SIZE (mm)	PACKING
TTLKJCL002A	Φ18X800MM	Bound Card
TTLKJCL002B	Φ18X1000MM	Bound Card

## JOINT KEY LOCK (TTLK-JKL011)

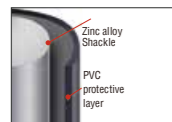

### Technical Data

- Joint key Lock With Keyed lock, specially designed as a flexible lock that is extra secure and very tough to break.
- This lock is ideal to lock up a bike, a ladder, construction equipment, and many other applications.



Product Number	SIZE (mm)	PACKING
TTLJKL011	Φ22X1000mm	Tie On Card

## JOINT KEY LOCK (TTLK-JKL012)

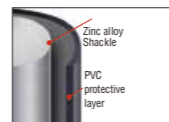

### Technical Data

- Joint key Lock With Keyed lock, specially designed as a flexible lock that is extra secure and very tough to break.
- This lock is ideal to lock up a bike, a ladder, construction equipment, and many other applications.



Product Number	SIZE (mm)	PACKING
TTLJKL012	Φ22X1000mm	Tie On Card

## JOINT COMBINATION LOCK (TTLK-JCL003)



### Technical Data

- 5-digit resettable code offering 100,000 combinations.
- The combination design is convenient to use and well suited for the use by several users.
- Available in different lengths.
- Set your own combination as often as you like.
- You can lock your bike/motorcycle by itself, or attach it to a fixed object (e. g. fence, lamppost, road sign.....)

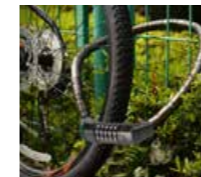

Product Number	SIZE (mm)	PACKING
TTLKJCL003A	Φ18X800MM	Bound Card
TTLKJCL003B	Φ18X1000MM	Bound Card

## JOINT COMBINATION LOCK (TTLK-JCL004)



### Technical Data

- 5-digit resettable code offering 100,000 combinations.
- The combination design is convenient to use and well suited for the use by several users.
- Available in different lengths.
- Set your own combination as often as you like.
- You can lock your bike/motorcycle by itself, or attach it to a fixed object (e. g. fence, lamppost, road sign.....)

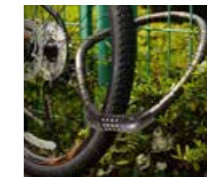

Product Number	SIZE (mm)	PACKING
TTLKJCL004A	Φ18X800MM	Bound Card
TTLKJCL004B	Φ18X1000MM	Bound Card

## CHAIN LOCK (TTLK-CL001)



### Technical Data

- 5-digit resettable code .
- The combination design is convenient to use and well suited for the use by several users.
- Available in different lengths.
- Set your own combination as often as you like.
- You can lock your bike/motorcycle by itself, or attach it to a fixed object (e. g. fence, lamppost, road sign.....)



Product Number	SIZE (mm)	PACKING
TTLKCL001A	Φ18X850mm	Sleeve On Card
TTLKCL001B	Φ18X1000mm	Sleeve On Card

## CHAIN LOCK (TTLK-CL002)



### Technical Data

- 5-digit resettable code .
- The combination design is convenient to use and well suited for the use by several users.
- Available in different lengths.
- Set your own combination as often as you like.
- You can lock your bike/motorcycle by itself, or attach it to a fixed object (e. g. fence, lamppost, road sign.....)



Product Number	SIZE (mm)	PACKING
TTLKCL002	Φ6X90MM	Sleeve On Card

## CHAIN LOCK (TTLK-UL005)



### Technical Data

- 5-digit resettable code .
- The combination design is convenient to use and well suited for the use by several users.
- Available in different lengths.
- Set your own combination as often as you like.
- You can lock your bike/motorcycle by itself, or attach it to a fixed object (e. g. fence, lamppost, road sign.....)



Product Number	SIZE (mm)	PACKING
TTLKCL005	Φ5.5X90MM	Sleeve On Card

## CHAIN LOCK (TTLK-UL006)



### Technical Data

- 5-digit resettable code .
- The combination design is convenient to use and well suited for the use by several users.
- Available in different lengths.
- Set your own combination as often as you like.
- You can lock your bike/motorcycle by itself, or attach it to a fixed object (e. g. fence, lamppost, road sign.....)



Product Number	SIZE (mm)	PACKING
TTLKCL006	Φ5.5X90MM	Sleeve On Card

## CHAIN LOCK (TTLK-CL003)



### Technical Data

- 5-digit resettable code .
- The combination design is convenient to use and well suited for the use by several users.
- Available in different lengths.
- Set your own combination as often as you like.
- You can lock your bike/motorcycle by itself, or attach it to a fixed object (e. g. fence, lamppost, road sign.....)



Product Number	SIZE (mm)	PACKING
TTLKCL003	Φ5.5X90MM	Sleeve On Card

## CHAIN LOCK (TTLK-CL004)



### Technical Data

- 5-digit resettable code .
- The combination design is convenient to use and well suited for the use by several users.
- Available in different lengths.
- Set your own combination as often as you like.
- You can lock your bike/motorcycle by itself, or attach it to a fixed object (e. g. fence, lamppost, road sign.....)



Product Number	SIZE (mm)	PACKING
TTLKCL004	Φ5.5X90MM	Sleeve On Card

## CHAIN LOCK (TTLK-UL007)



### Technical Data

- 5-digit resettable code .
- The combination design is convenient to use and well suited for the use by several users.
- Available in different lengths.
- Set your own combination as often as you like.
- You can lock your bike/motorcycle by itself, or attach it to a fixed object (e. g. fence, lamppost, road sign.....)



Product Number	SIZE (mm)	PACKING
TTLKCL007	Φ18X1200MM	Sleeve On Card

## CHAIN LOCK (TTLK-UL008)



### Technical Data

- Integrated Silicon Molded Design: Easy-to-clean and won't scratch your bike
- Mounting Bracket System: Includes transportation bracket system for versatile carrying
- Fits easily into your back pocket, hang on handlebars or place in messenger bag/backpack



Product Number	SIZE (mm)	PACKING
TTLKCL008	Φ8X1200MM	Sleeve On Card

## SPIRAL CABLE LOCK (TTLK-SCL001)



### Technical Data

- Integrated Silicon Molded Design: Easy-to-clean and won't scratch your bike
- Mounting Bracket System: Includes transportation bracket system for versatile carrying
- Fits easily into your back pocket, hang on handlebars or place in messenger bag/backpack

Product Number	SIZE (mm)	PACKING
TTLKSC001A	Φ12/15X1000MM	Bound Card
TTLKSC001B	Φ12/15X1500MM	Bound Card
TTLKSC001C	Φ12/15X1800MM	Bound Card

## SPIRAL CABLE LOCK (TTLK-SCL002)



### Technical Data

- Integrated Silicon Molded Design: Easy-to-clean and won't scratch your bike
- Mounting Bracket System: Includes transportation bracket system for versatile carrying
- Fits easily into your back pocket, hang on handlebars or place in messenger bag/backpack

Product Number	SIZE (mm)	PACKING
TTLKSC002	Φ10/12X1000MM	Bound Card

## COMBINATION CABLE LOCK (TTLK-CCL001)



### Technical Data

- 4-digit resettable code .
- The combination design is convenient to use and well suited for the use by several users.
- Available in different lengths.
- Set your own combination as often as you like.
- You can lock your bike/motorcycle by itself, or attach it to a fixed object (e. g. fence, lamppost, road sign.....)

Product Number	SIZE (mm)	PACKING
TTLKCCL001A	Φ6/8/10X1000MM	Bound Card
TTLKCCL001B	Φ6/8/10X1200MM	Bound Card
TTLKCCL001C	Φ6/8/10X1500MM	Bound Card
TTLKCCL001D	Φ6/8/10X1800MM	Bound Card

## COMBINATION CABLE LOCK (TTLK-CCL002)



### Technical Data

- 4-digit resettable code .
- The combination design is convenient to use and well suited for the use by several users.
- Available in different lengths.
- Set your own combination as often as you like.
- You can lock your bike/motorcycle by itself, or attach it to a fixed object (e. g. fence, lamppost, road sign.....)

Product Number	SIZE (mm)	PACKING
TTLKCCL002A	Φ6/8/10X1000MM	Bound Card
TTLKCCL002B	Φ6/8/10X1200MM	Bound Card
TTLKCCL002C	Φ6/8/10X1500MM	Bound Card
TTLKCCL002D	Φ6/8/10X1800MM	Bound Card

## SPIRAL CABLE LOCK (TTLK-SCL003)



### Technical Data

- Integrated Silicon Molded Design: Easy-to-clean and won't scratch your bike
- Mounting Bracket System: Includes transportation bracket system for versatile carrying
- Fits easily into your back pocket, hang on handlebars or place in messenger bag/backpack

Product Number	SIZE (mm)	PACKING
TTLKSC003	Φ10/12X1000MM	Bound Card

## SPIRAL CABLE LOCK (TTLK-SCL004)



### Technical Data

- Integrated Silicon Molded Design: Easy-to-clean and won't scratch your bike
- Mounting Bracket System: Includes transportation bracket system for versatile carrying
- Fits easily into your back pocket, hang on handlebars or place in messenger bag/backpack

Product Number	SIZE (mm)	PACKING
TTLKSC004A	Φ6/8/10X1000MM	Bound Card
TTLKSC004B	Φ6/8/10X1200MM	Bound Card
TTLKSC004C	Φ6/8/10X1500MM	Bound Card
TTLKSC004D	Φ6/8/10X1800MM	Bound Card

## COMBINATION CABLE LOCK (TTLK-CCL003)



### Technical Data

- 4-digit resettable code .
- The combination design is convenient to use and well suited for the use by several users.
- Available in different lengths.
- Set your own combination as often as you like.
- You can lock your bike/motorcycle by itself, or attach it to a fixed object (e. g. fence, lamppost, road sign.....)

Product Number	SIZE (mm)	PACKING
TTLKCCL003A	Φ6/8/10X1000MM	Bound Card
TTLKCCL003B	Φ6/8/10X1200MM	Bound Card
TTLKCCL003C	Φ6/8/10X1500MM	Bound Card
TTLKCCL003D	Φ6/8/10X1800MM	Bound Card

## COMBINATION CABLE LOCK (TTLK-CCL004)



### Technical Data

- 4-digit resettable code .
- The combination design is convenient to use and well suited for the use by several users.
- Available in different lengths.
- Set your own combination as often as you like.
- You can lock your bike/motorcycle by itself, or attach it to a fixed object (e. g. fence, lamppost, road sign.....)

Product Number	SIZE (mm)	PACKING
TTLKCCL004A	Φ6/8/10X1000MM	Bound Card
TTLKCCL004B	Φ6/8/10X1200MM	Bound Card
TTLKCCL004C	Φ6/8/10X1500MM	Bound Card
TTLKCCL004D	Φ6/8/10X1800MM	Bound Card

## COMBINATION CABLE LOCK (TTLK-CCL005)



### Technical Data

- 4-digit resettable code .
- The combination design is convenient to use and well suited for the use by several users.
- Available in different lengths.
- Set your own combination as often as you like.
- You can lock your bike/motorcycle by itself, or attach it to a fixed object (e. g. fence, lamppost, road sign.....)

Product Number	SIZE (mm)	PACKING
TTLKCC005	Φ8/10X1200MM	Bound Card

## COMBINATION CABLE LOCK (TTLK-CCL006)



### Technical Data

- 4-digit resettable code .
- The combination design is convenient to use and well suited for the use by several users.
- Available in different lengths.
- Set your own combination as often as you like.
- You can lock your bike/motorcycle by itself, or attach it to a fixed object (e. g. fence, lamppost, road sign.....)

Product Number	SIZE (mm)	PACKING
TTLKCC006	Φ5.5X90MM	Bound Card

## COMBINATION CABLE LOCK (TTLK-CCL009)



### Technical Data

- 4-digit resettable code .
- The combination design is convenient to use and well suited for the use by several users.
- Available in different lengths.
- Set your own combination as often as you like.
- You can lock your bike/motorcycle by itself, or attach it to a fixed object (e. g. fence, lamppost, road sign.....)

Product Number	SIZE (mm)	PACKING
TTLKCC009	Φ10X600MM	Bound Card

## COMBINATION CABLE LOCK (TTLK-CCL010)

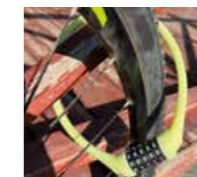

### Technical Data

- 5-digit resettable code .
- The combination design is convenient to use and well suited for the use by several users.
- Available in different lengths.
- Set your own combination as often as you like.
- You can lock your bike/motorcycle by itself, or attach it to a fixed object (e. g. fence, lamppost, road sign.....)

Product Number	SIZE (mm)	PACKING
TTLKCC010	Φ10X600MM	Bound Card

## COMBINATION CABLE LOCK (TTLK-CCL007)



### Technical Data

- 4-digit resettable code .
- The combination design is convenient to use and well suited for the use by several users.
- Available in different lengths.
- Set your own combination as often as you like.
- You can lock your bike/motorcycle by itself, or attach it to a fixed object (e. g. fence, lamppost, road sign.....)

Product Number	SIZE (mm)	PACKING
TTLKCC007A	Φ12/15X1000MM	Bound Card
TTLKCC007B	Φ12/15X1500MM	Bound Card
TTLKCC007C	Φ12/15X1800MM	Bound Card

## COMBINATION CABLE LOCK (TTLK-CCL008)



### Technical Data

- 5-digit resettable code .
- The combination design is convenient to use and well suited for the use by several users.
- Available in different lengths.
- Set your own combination as often as you like.
- You can lock your bike/motorcycle by itself, or attach it to a fixed object (e. g. fence, lamppost, road sign.....)

Product Number	SIZE (mm)	PACKING
TTLKCC008A	Φ12/15X1000MM	Bound Card
TTLKCC008B	Φ12/15X1500MM	Bound Card
TTLKCC008C	Φ12/15X1800MM	Bound Card

## COMBINATION CABLE LOCK (TTLK-CCL011)

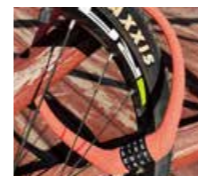

### Technical Data

- 4-digit resettable code .
- The combination design is convenient to use and well suited for the use by several users.
- Available in different lengths.
- Set your own combination as often as you like.
- You can lock your bike/motorcycle by itself, or attach it to a fixed object (e. g. fence, lamppost, road sign.....)

Product Number	SIZE (mm)	PACKING
TTLKCC011	Φ10X600MM	Bound Card

## COMBINATION CABLE LOCK (TTLK-CCL012)



### Technical Data

- 5-digit resettable code .
- The combination design is convenient to use and well suited for the use by several users.
- Available in different lengths.
- Set your own combination as often as you like.
- You can lock your bike/motorcycle by itself, or attach it to a fixed object (e. g. fence, lamppost, road sign.....)

Product Number	SIZE (mm)	PACKING
TTLKCC012	Φ10X600MM	Bound Card

## MULTIFUNCTIONAL LOCK (TTLK-ML001)



### Technical Data

- Suitable for theft prevention of bicycles, boats, lawnmowers, and other equipment.



Product Number	SIZE (mm)	PACKING
TTLKML001	Φ10X600MM	Sleeve On Card

## MULTIFUNCTIONAL LOCK (TTLK-ML002)



### Technical Data

- Suitable for theft prevention of bicycles, boats, lawnmowers, and other equipment.



Product Number	SIZE (mm)	PACKING
TTLKML002	Φ12X600MM	Sleeve On Card

## MULTIFUNCTIONAL LOCK (TTLK-ML003)



### Technical Data

- Suitable for theft prevention of bicycles, boats, lawnmowers, and other equipment.



Product Number	SIZE (mm)	PACKING
TTLKML003	Φ10X1000MM	Hanging Tag

## MULTIFUNCTIONAL LOCK (TTLK-ML004)



### Technical Data

- Suitable for theft prevention of bicycles, boats, lawnmowers, and other equipment.



Number	SIZE (mm)	PACKING
TTLKML004A	Φ12X1000MM	Hanging Tag
TTLKML004B	Φ12X1500MM	Hanging Tag

## WALL AND GROUND ANCHOR (TTLK-WAGA001)



### Technical Data

- Size of anchor plate H x W x D: approx. 4.5 x 12 x 5.5 cm
- Diameter of ring: approx. 10 cm
- Ring thickness: approx. 1.4 cm
- Weight: approx. 0.8 kg
- Material: Steel (hardened), plastic
- Colour: Black



Product Number	SIZE (mm)	PACKING
TTLKWAGA001	12X5.5X4.5CM	Sleeve On Card

## WALL AND GROUND ANCHOR (TTLK-WAGA002)



### Technical Data

- Size of anchor plate H x W x D: approx. 4.5 x 12 x 5.5 cm
- Diameter of ring: approx. 10 cm
- Ring thickness: approx. 1.4 cm
- Weight: approx. 0.8 kg
- Material: Steel (hardened), plastic
- Colour: Black



Product Number	SIZE (mm)	PACKING
TTLKWAGA002	12X5.5X4.5CM	Sleeve On Card

## WALL AND GROUND ANCHOR (TTLK-WAGA003)



### Technical Data

- For theft protection
- For bicycles, motorbikes and much more
- Made of robust steel
- Incl. fastening material
- For indoor & outdoor use



Product Number	SIZE (mm)	PACKING
TTLKWAGA003	12X12.5X13.5CM	Hanging Tag

## WALL AND GROUND ANCHOR (TTLK-WAGA004)



### Technical Data

- Anti-theft
- For bikes, motorcycles and more
- Resistant to sawing and hammering
- Robust steel construction
- Includes mounting fixings



Product Number	SIZE (mm)	PACKING
TTLKWAGA004A	13X7.9X5.3CM	Hanging Tag
TTLKWAGA004B	13X6.3X5.3CM	Hanging Tag